

**RURAL
CEMETERIES
OF
McDONOUGH COUNTY, ILLINOIS**

**VOLUME XV
EMMET TOWNSHIP**

**BY DUANE LESTER
GOOD HOPE, ILLINOIS**

**PRINTED BY
SCHUYLER – BROWN
HISTORICAL AND GENEALOGICAL SOCIETY
AND
THE SCHUYLER JAIL MUSEUM**

“A monument is erected
not because a person died,
but because a person lived.”

Volume XV

Table of Contents

Preface	i – ii
Maps and plats	iii – iv....ix-xiv
McDonough County, Illinois	iii
Areas Covered in Volumes I - XVII	iv
Section 5: Emmet Township, T6N R3W, 1871	v
Section 11: Emmet Township, T6N R3W, 1871	vi
Section 8: Emmet Township, T6N R4W, 1871	vii
Head Graveyard	1 - 2
Spring Creek Cemetery	3 - 22
Stickle Cemetery	23 - 34
Walker Cemetery	35 - 42

Preface

Within the boundaries of McDonough County, Illinois are more than a hundred cemeteries and gravesites ranging in size from a single burial site to the expansive Oakwood Cemetery at Macomb. Within these cemeteries are the remains of an estimated 40,000 individuals who have died since the first settler arrived here over 150 years ago. Graves of countless others are scattered over the countryside of McDonough County; but, exact sites of many of these resting places are no longer known for various reasons. During the early days of this county, there were obviously no central burial grounds; thus, a pioneer family having the misfortune of losing one of its members placed the deceased in a grave on a family homestead and erected a makeshift marker. A number of these family burial grounds later became public cemeteries, however, many of the grave sites soon became "lost". Crude wooden markers or hand engraved stone soon succumbed to the elements and were never replaced; scores of families moved further west after staying in this area only a short time and the gravesites of their loved ones shortly became insignificant mounds of earth; a number of families passing through this vicinity suffered individual losses. A prime example of the latter is contained in a history of Bethel Township. In 1830, four children of an emigrant family died while en route through McDonough County. They were buried near their places of death which occurred about two miles southwest of Fandon. All traces of those graves have long been gone. During the summer of 1834, a widow lady died at her home in northern Tennessee Township. Her coffin of dressed walnut lumber was built by a local cabinet maker and she was buried in the timber near her home. Within a few years, no evidence remained to indicate the presence of her final resting place. A family who created an excellent farm from the prairies a few miles north of Macomb, maintained a fenced family burial site for several years. This cemetery contained the graves of about 12 former family members. During the early 1900's, the farm changed ownership. Shortly thereafter, the new owner removed all the stones, took down the fence and this graveyard became part of a cornfield. These are only three of the countless incidents involving the total disappearance of burial sites. At this time, it is impossible to determine the locations of hundreds of individual's graves in this county.

Vandalism is responsible for the destruction of many grave stones. Countless markers have been partially or totally destroyed. Inscriptions have been obliterated by gunshot blasts, stones have been broken into dozens of pieces, and some markers have been entirely removed from their original locations.

While weather-wear and vandalism accounts for most of the destruction of individual tombstones, neglect is directly responsible for the eventual deterioration of graveyards. Several local cemeteries have had no protective fencing for a number of years and the grounds have become grazing land for livestock. Groundhogs and other burrowing animals have undermined large portions of various cemeteries. Some areas are nearly invisible because of massive growth of weeds and brush. Stones have fallen, broken, and become completely covered with soil and debris.

The overall condition of our county cemeteries is a pathetic case. While some grounds are well maintained, or at least partially kept-up by various families, many have been totally forgotten. This situation is appalling and should never have come about. Apparently, lack of time, expense, and most of all regard has brought about the present-day poor conditions of many of our rural cemeteries.

Genealogical notes accompanying the various cemetery listings were prepared from a wide variety of sources including: Local area history books and atlases; newspaper files; county, state, and federal archives; family histories. These notes were collected at random from readily available sources and little, or no attempts were made to search for material for more complete genealogies. These notes are presented only for the purposes of identification and/or clarification.

Every attempt has been made to present complete and accurate information. Readers will find errors and omissions. Others will not agree with portions of my findings; however, no information contained herein is based solely on assumption or guesswork. It must be remembered that this information has been prepared for use only as a tool for further research and that nothing must be taken as final and absolute.

The larger cemeteries contained in these volumes are accompanied by grave location charts. These charts in no way are intended to represent any professionally prepared plat or survey that may exist. Their preparation and presentation are solely for general location purposes.

When copying inscriptions from grave markers, it is sometimes impossible to read some portions of the engraving. Names, dates, ages, etc. that were found to be unclear or totally missing are indicated by the use of question marks or dashes, i.e., SPICER, James T., infant son of ?J.B. & S.J.?.; d. ____; age _____. The letters or numbers enclosed in parenthesis following the inscription, indicated general location as indicated on the accompanying chart.

Abbreviations used are as follows:

b. born	m. months
Cav. Cavalry	md. married
Co. County/Company	sec. section
d. died/days	twp. township
dau. daughter	y. years
Inf. Infantry	

Time and space prohibits proper recognition for all those individuals who gave assistance in preparing and publishing these volumes. Deep and sincere appreciation is extended to all concerned, especially to the following: My parents, Mr. and Mrs. Lloyd Lester, and my wife, Rose; and to Mrs. Lavina Walton and other members of the Schuyler County Historical and Genealogical Society for printing and binding the finished product. Thank you.

Duane Lester

ADDENDUM

Mr. Lester's Magnum Opus is nothing short of monumental. It is not easy to gain access to many of these historic family burial sites. By the time of Mr. Lester's survey (1970's) numerous plots were long left abandoned, overgrown with trees and weeds and monuments under attack by weather, livestock, vandals, and property owners who did not care about the burial sites of McDonough County's brave pioneers. Thankfully, we now (2012) have laws to protect our county's historical legacy and these final resting gardens.

I am in awe of Mr. Lester for his transcriptions of hard-to-read tombstones and his laborious typing of his 18 Volumes of the Rural Cemeteries of McDonough County. He did not have access to a computer. In addition to transcribing information from tombstones, he had to painstakingly access county records (e.g. 1840 county tax list), federal census records, and local newspapers requiring a great deal of time and effort. As a genealogist in 2012, I have access to the internet with fast access to US Census records, Family Search (records kept by the Church of Jesus Christ of Latter-Day Saints) and numerous other legal documents, books, and family journals. Mr. Lester used an old-fashioned key-strike, ribbon tape typewriter where mistakes were hard to correct and appear as overstrikes. There are very few attesting to his skill as a typist. What an US Census record will not contain are the names and dates of infants who died between census surveys. Mr. Lester's tombstone records give names and dates of children, whose lives were brief, but would otherwise be lost to history without his efforts. Frequently, he provides names of brothers and sisters, fathers and mothers that allows for completion of family group sheets.

Another work of love for those who dared to settle the prairie lands of western Illinois and raise their families is being performed by Dr. A. Gil Belles. He has been able to install signs for each of these rural cemeteries and provide GPS (Global Positioning System) information making it easier for anyone wishing to visit a rural cemetery to help them actually find it. Gil also works closely with Boy Scouts and other civic groups to help cleanup, clear brush and dead trees, locate buried tombstones, and restore stones. My revision of Mr. Lester's document will provide information on all cemetery restoration projects.

Any changes made to Mr. Lester's original work was done in blue color font. His maps were scanned and copied into the text and remain like his original work and are not subject to editing. His text was transcribed using MS Word, enabling me to control font size and color. Retyping text also leaves room for typo errors. Mr. Lester's rare typo errors are corrected but not displayed in blue. This MS Word document allows on-the-fly editing of any "Notes, Corrections, Additions, and Changes" found at the end of every cemetery. This was Mr. Lester's intent to produce a working document and improve accuracy about the information on those buried. I have retyped state abbreviations as they are now used (e.g. IL, instead of Ill.). On 1840 county tax lists I omitted cents (e.g. \$140, instead of \$140.00). The current MS Word font uses less space, thus, placing more text per line. This shrinks his documents and reduces pages. This, then, changes page numbering in each Table of Contents. Cemetery locations are also found on the internet. See: **McDonough County Illinois Cemeteries** <http://graveyards.com/graveyards/IL/McDonough>

HEAD CEMETERY

Location: Emmet Township, NW¼, Section 5; 5 miles west of Good Hope on Illinois Route 9, about ¾ mile south thru private property (no roads exist to this cemetery). [From Illinois Hwy 9 turn south on E750th St for ½ mile then west on N1800 Rd for about ½ mile to a road that turns south for about 200 yards. The cemetery is back about 75 yards to the west. 40° 32' 37.2" N: 90° 46' 16" W](#)

Remarks: This small area is loosely fenced with barbed wire; immediate area is currently pasture land; the cemetery grounds are totally unmaintained; dense grass and brush have overgrown the area; stones are broken, overturned, and buried in several inches of sod. A few markers were located outside the fenced area. This registration was in 1973.

BROADDUS:

Charlie, son of R. & S.E.; d. Sep 3, 1851; age 9m 6d.
Mellie, son of R.E. & S.E.; d. Mar 16, 1859; age 5m 13d.
Martha E., wife of B.F.; d. Jul 18, 18--; age 30y 8m 3d.

BAILEY:

Patsey B., wife of John M.; d. Jan 25, 1849; age 31y 11m 16d.

CLARK:

Benjamin; b. Jul 17, 1777; d. Apr 3, 1853; age 75y 8m 17d.
Polly H., wife of B.; b. Apr 2, 1777; d. Jun 13, 1853.

GILLIHAN:

Stephen F., son of S.H. & S.T., d. Aug 2, 1853; age 6m 4d.

HAINLINE:

Infant dau of J.M. & S.B.; d. Sep 8, 1843.

HEAD:

Mary M., wife of George; d. Dec 22, 1852; age 43y 8m 9d.
Martha C., dau of T.W. & Isabel; d. Aug 31, 1852; age 1y 10m 15d.
Thomas W., son of T.W. & I.; d. Jul 1, 1868; age 7m 16d.
James D.; d. Mar 1, 1861; age 83y 7m 20d.
Isabella E., wife of James; d. Aug 22, 1876; age 85y 6m 19d.

MC HEAD:

James D.; d. Mar 30, 1854; age 37y 4m 15d.

WALKER:

Margaret A., dau of H.M. & E.U.; d. Aug 6, 1852; age 2m 7d.

Genealogical Notes – Head Cemetery

BAILEY: 1850 census #247; John M., 43, farmer, VA; Margaret, 26, IN; Elizabeth, 17, KY; John H., 15, IL; James, 13, IL; Joseph, 11, IL; Margaret, 9, IL; Ataline, 7, IL; Susan, 6, IL; Wm. W., 4, IL; and Edward L., 2, IL.

BROADDUS: 1850 census #22; Robert, 24, blacksmith, KY; Emily S., 19, IL; H.A., 9 mos., male, IL; Sarah, 52, KY.

Benjamin married Martha Emmeline Head on Apr 10, 1850. 1850 census #89; B.F., 21, cabinet maker, KY; Martha E., 19, KY. Benj. F. was defeated by a slim margin for coroner in 1854 and again in 1856.

CLARK: Benjamin Clark moved to Section 30, Sciota Twp. in 1838 from KY; lived there till his death in 1853. 1850 census #205; Benjamin, 73, farmer, VA; Mary, 73, MD; Simion, 37, farmer, KY; Mary E., 5, IL; Maria PORTER, 16, IL.

GILLIHAN: Stephen F. was a son of Stephen & Sarah (Clark) Gillihan, who were married in this county on Oct 7, 1844.

HAINLINE: (Court records) Infant female died at age 3 days on Jan 3, 1882 of bronchitis; buried at Head Graveyard.

HEAD: James Head a native of VA and moved to KY at an early age; moved to Emmet Twp. about 1832; settled on section 5; lived there till 1855 and moved to Macomb; died there Mar 2, 1863 (stone reads Mar 1, 1861); raised 12 children; 3 remained in this area in the late 1800's; Thomas W.; Maria, the wife of Jefferson Hays; William B. The Head family arrived in this county on Christmas day of 1832.

George Head bought a Macomb hotel built in 1831 by James Clark; later sold to Silas French and later owned, in 1850, by Thomas A. Brooking.

Thomas W. Head moved to Emmet Twp. in 1832 with his parents; in Mar 1848 moved to Sciota Twp. and settled on section 32; later moved to town of Sciota; had 2 sons – in business in Sciota and Good Hope. (Sons of T.W. Head were Albert and Joseph M.; opened grocery store in Sciota in 1882). Thomas Head sold a 2A lot from his farm for use as a public cemetery; received \$200 for it; this later became Spring Creek Cemetery. Thomas W. died in 1897; Isabel P. Head died in 1921; both buried at Spring Creek Cemetery, Emmet Twp.

Isabel, wife of Thomas W. Head; the eldest child of Tobias George PAINTER; he a native of Westmoreland Co. PA; family moved to Beardstown, IL in 1831; later to the Spring Creek area of Emmet Twp.; also lived about 3 years on section 8, Industry Twp. Tobias G. Painter died in 1879 at age of 72; buried in Stickle Cemetery, Emmet Twp. Her mother was Catherine Painter, a native of PA.

1850 census #231; James, 67, farmer, MD; Ebby, 56, VA; James, 25, farmer, KY; Ellen, 15, IL; John HADEN, 11, IL; John WHITE, 20 farm laborer, KY.

Notes, Corrections, Additions, and Changes

SPRING CREEK CEMETERY

Location: Emmet Township: SE¼, Section 5; 2 miles northwest of Spring Lake. From Illinois Hwy 9 turn south on E750th St for 1 mile then east on N1750 Rd for about ½ mile. 40° 32' 16.2" N: 90° 45' 15.7" W

Remarks: Also known as Humbert, Sciota, Russell, or Spring Grove Cemetery. The grounds are fenced; overall maintenance is poor; only a few family plots are kept reasonably free of weeds and brush; a number of stones have been broken, overturned, or otherwise damaged. The following information was gathered in mid – 1973.

N1750 RD

Section NW	Section NC	Section NE
Section WC	Section C	Section EC
Section SW	Section SC	Section SE

ALLSHOUSE:

Hannah; b. Sep 5, 1849; d. Dec 17, 1906; age 57y 3m 12. (NC)
 Israel; Feb 4, 1820 – Mar 13, 1904; age 84y. (NC)
 Lucinda, wife of Israel; Jan 31, 1825 – Feb 20, 1873; age 48y. (NC)
 Mary J. (See BARKER).

ANDERSON:

Amanda, wife of William; d. Mar 4, 1878; age 27y 5m 26d. (SW)
 Margaret A., dau of Wm. & A.; d. Jun 28, 1880; age 8y 4m 8d. (SW)

ATKINSON:

Mary J., wife of H.O.; d. Apr 30, 1883; age 49y 9m 22d. (NW)

BARKER:

Enoch; 1848 – 1918. (WC)
 Mary J. Allshouse; 1847 – 1923. (WC)
 Infant dau of E. & M.J.; b. Aug 15, 1888; d. Mar 10, 1889. (NC)

BLACK:

Fannie, dau of S.H. & M.M.; d. Dec 5, 1872; age 6y 2m 11d. (NC)
 Henry E., son of S.H. & M.M.; d. Mar 17, 1862; age 2y 7m 3d. (NC)
 -----, child of S.H. & M.M.; d. Oct, 21, 185--; age -----. (NC)

BLAND:

Elizabeth, wife of A.; b. Sep 12, 1812; d. Oct 23, 1893. (NC)
Allen; d. Jun 27, 1853; age 42y 5m 11d. (NC)
Parthena, dau of A. & E.; died Apr 1847; age 4m. (NC)
Jane, wife of S.; d. Oct 1847; age 63y. (NC)
Dora C., dau of S. & M.; 1880 – 1898. (SC)
Joe; 1870 – 1947. (SC)
Effie; 1873 – 1909. (SC)
Lettie; 1895 – 1911. (SC)
Roscoe; 1888 – 1902. (SC)
Glen; 1903 – 1903. (SC)
William W., son of R. & E.; 1909 – 1910. (SC)

BONWELL:

Telila; 1857 – 1885. (NE)

BRILEY:

Sarah (See MOSS)

BROWN:

Ezra, M.D.; 1841 – 1880. (NW)
Marilla; 1847 – 1880. (NW)

BUGHMAN (BUCHMAN):

Infant son of J. & C.; d. Nov 17, 1852; age 21d. (NW)
Infant son of J. & C.; d. Apr 19, 1854; age ----. (NW)
George C., son of J. & C.; d. Nov 12, 1861; age 18y 4m 9d. (NW)
Flore E., dau of J. & C.; d. Sep 2, 1859; age 6y 11m 5d. (NW)
Celia, wife of J.; d. May 14, 1854; age 39y 22d. (NW)

CAHILL:

William; d. Aug 16, 1883; age 58y. (NE)
Doara, dau of W. & M.; d. Mar 3, 1877; age 4y 11m 7d. (NE)
Lurena Sherherd; d. Apr 8, 1879; age 28y 19d. (NE)

CHAMPION:

Mankin; d. Sep 12, 1865; age 73y 6m 28d. (NC) [\[b. Feb 15, 1792\]](#)
Edward; May 30, 1798 – Dec 15, 1878. (NC)
Joanna, wife of Edward; Feb 15, 1801 – Aug 9, 1878. (NC)
S. Lulu; Oct 23, 1872 – Mar 4, 1896. (NE)
Infant; Mar 2, 1889 – Mar 4, 1889. (NE)
(NOTE: Latter 2 children were those of John & Mary Champion).
Robert P., son of J.D. & M.; d. Apr 25, 1880; age ----. (NE)
Mary M.; 1844 – 1928. (NE)
Nancy J.; 1840 – 1920. (NE)
Robert M.; Mar 13, 1838 – Feb 22, 1903. (NE)
Mary; Aug 11, 1849 – Apr 18, 1932. (NE)
John D.; Mar 20, 1842 – May 28, 1909. (NE)
Louisa (See SWEENEY).

CHAPLIN:

Mary E., dau of G. & S.W.; d. Aug 31, 1852; age 11m 5d. (WC)
Nancy J., dau of J.D. & M.A. Hainline and wife of J. Chaplin; d. Mar 27, 1867; age 28y 2d. (SW)

CHARTER:

B.G.; 1827 – 1894. (NC)

CLARKE (CLARK):

William B.; Mar 31, 1819 – May 26, 1898. (NW)
Emma, wife of William B.; d. Jul 15, 1867; age 36y 11m 17d. (NW)
(Inscribed on this stone, "Infant son died same date").
Charley, son of W.B. & E.; d. Sep 4, 1862; age 8m 10d. (NW)
Berry L., son of W.B. & E.; d. Feb 9, 1861; age 1y 9m 16d. (NW)
Mary J., dau of W.B. & E.; d. Jan 8, 1855; age 10m 8d. (NW)
Samuel L.; d. Feb 8, 1863; age 39y 3m 10d. (NW)
Louisa C.; b. Jul 16, 1825; d. Feb 15, 1846. (C)
Thomas E., son of B.F. & M.J.; d. Mar 8, 1862; age 15m 9d. (C)
John S., son of B.F. & M.J.; d. Nov 8, 1848; age 3m 8d. (C)
Cora E., dau of B.F. & M.J.; d. Feb 25, 1853; age 1y 1m 22d. (C)

CLAYTON:

Mary Ann, wife of James; Mar 13, 1826 – Jan 22, 1899. (NC)

COLLINS:

Ruth (See GRILLS).

COTTON:

Deliah, dau of W.M.H. & S.L.; d. Jul 27, 1870; age 1y 28d. (WC)

DARLINGTON:

W.G.; Mar 8, 1828 – Jun 15, 1844. (NE)
Phebe; Feb 17, 1842 – Apr 2, 1930. (NE)

DAVIS:

Thurza, wife of Eli; d. Oct 8, 1852; age 68y 1m 3d. (NC) [\[b. Sep 5, 1784\]](#)

DEEMS:

Margaret G. (See TIPTON).

DRY:

Mary M., wife of Jacob; d. Jul 2, 1873; age 64y 5m 8d. (C) [handwritten is name Painter]
Jacob; d. Dec 6, 1873; age 66y 1m 10d. (C)
Lucy, wife of Cyrus; Feb 4, 1852 – Mar 10, 1875 (C)
Hubert, son of C. & E.; d. Nov 23, 1885; age 3y 9m 5d. (C)
Cyrus; Jul 29, 1838 – Dec 17, 1906. (C) [handwritten, son of Jacob & Mary]
Eliza Jane; May 1860 – May 3, 1934. (C)

DUGAN:

Absalom P., son of W.H. & M.A.; d. Sep 12, 1855; age ?13?m. (WC)

DUNCAN:

Peter C.; 1846 – 1921. (NC)
S.; d. Sep 20, 1865; age 56y. (NC)
Mary A., wife of Smith; d. Aug 27, 1871; age 57y 9m 11d. (NC)
Francis; d. Nov 20, 1870; age 28y 1m. (NC)
John H., son of J.B. & M.A.; d. Apr 1, 1870; age 10m 27d. (NC)
Mary Ann, wife of J.B.; Sep 26, 1842 – Mar 22, 1904. (NC)
William H.; 1833 – 1910. (NC)
-----, dau of J.R. & M.A.; d. -----, 1889; age ----. (NE)
?Napolen? H., son of S. & R.; d. Feb 6, 1861; age 1y 3m 11d. (NC)

ENGLISH:

Cummins B.; Apr 23, 1821 – Nov 11, 1907. (NW)
Minerva; Sep 6, 1821 – Jan 13, 1902. (NW)
Mary A.; Sep 17, 1851 – Jul 30, 1871. (NW)
James F.; Oct 7, 1862 – Jun 7, 1880 (NW)
Marcellus L.; Dec 7, 1859 – Sep 16, 1908. (NW)
Robert W.; Jan 17, 1856 – Jan 1, 1934. (NW)
Thedocia E. Humberd; Apr 10, 1860 – Dec 14, 1928. (NW)
Francis M.; 1878 – 1916. (NC)
Rebecca A.; 1859 – 1929. (NC)
John D.; 1853 – 1930. (NC)
Minerva, wife of L.M.; May 12, 1849 – Jan 13, 1893. (SC)

FERGUSON:

William; d. Feb 22, 1862; age 61y. (NC)
Ellen, wife of William; d. Jan 31, 1872; age 63y 8m 22d. (NC)

FERINGTON:

Luther, Rev.; d. Mar 24, 1837; age 58y. (C) [\[b. 1779\]](#)

FOLEY:

Birdie, son of T.F. & J.C.; d. Mar 18, 1877; age –m 17d. (NW)
Lester, son of T.F. & J.C.; d. Feb 1, 1881; age 2y 10m. (NW)

GLEASON:

Myrtle B.; d. Jun 22, 1906; age 10y 11m 10d. (NE)

GODDARD:

Percy A.; d. Mar 30, 1876; age 89y 2m 20d. (NW)
(NOTE: On same stone as John H. & Charles O. Head).

GOODMAN:

Sarah T., wife of J.A.; d. Mar 10, 1870; age 52y 9m. (NC)
Infant dau of J.A. & S.T.; d. Apr 10, 1859. (NC)
Stith A., son of J.A. & S.T.; d. Mar 5, 1855; age 5m 12. (NC)
Ethelean, son of J.A. & S.T.; d. Dec 5, 1877; age 17y 6m 1d. (NC)

GRAHAM:

Mary W., wife of H.H.; d. Jun 26, 1874; age 32y 9m 20d. (C)

GRAVES:

Henry W.; 1856 – 1928. (SC)
Sarah K.; 1862 – 1941. (SC)
Felix J.; 1881 – 1906. (SC)
Bennie G.; 1899 – 1928. (SC)

GRIFFITH:

Virginia A. (See HAINLINE)

GRILIS:

Margaret T.; 1863 – 1925. (EC)
Jones D.; 1860 – 1883. (EC)
Mary L.; 1834 – 1912. (EC)
William P.; 1830 – 1881. (EC)
Ruth Collins; 1861 – 1889. (EC)
Thomas R.; 1856 – 1926. (EC)
Tommy, dau of Thomas R. & Ruth; 1889 – 1889. (EC)

HAINLINE:

Infant son of B. & S.R.; d. Apr 15, 1876; age----. (NW)
Virginia A. Griffith; Sep 5, 1843 – Feb 22, 1941. (WC)
Joseph H.; Feb 2, 1837 – Jan 12, 1882. (WC)
Elizabeth A., wife of D.T.; d. Jun 22, 1867; age 41y 7m 4d. (NW)
David T.; d. Jul 29, 1865; age 38y 1m 22d. Govt marker reads, "Co I, 124th IL Inf." (NW)
Amanda J.; d. Oct 19, 1863; age 3y. (NW)
Effie A.; d. Sep 15, 1866; age 9m 2d. (NW)
Mary; d. Jul 12, 1870; age-----. (NW)
(NOTE: Latter 3 children were daughters of L.S. & H.G. Hainline).
Henry C., son of J. & M.; d. Dec 2, 1862; age 31y 9m 19d. (NW)
Mary, wife of John; d. Nov 6, 1871; age 68y 2m 25d. (NW)
John; d. Jun 28, 1861; age 65y 3m 11d. (NW)
Infant dau of D.T. & E.A.; d. Jun 3, 1858; age ----. (NW)
John, son of J. & M.; d. Oct 15, 1840; age 6y 27d. (NW)
Andrew J.B., son of T.S. & L.A.; d. Nov 23, 1867; age 14y 1m 13d. (SW)
J. Lincoln; 1860 – 1939. (NW)
Mary S.; 1861 – 1937. (NW)
Flora R., wife of George; d. Sep 15, 1871; age 75y 6m. (NW)
George; b. Jun 1, ?1791?; d. Apr 11, 1869; age 78y 10m 10d. (NW) [b. should be Jun 1, 1790]
Clara E., dau of G.L. & A.E.; d. Jun 10, 185--; age 4m 11d. (NW)
Thaddeus C.S., son of A.J. & J.; d. Mar 5, 1851; age 1m 18d. (NW)
Jacob Ennis, son of ?G? & F.; d. Apr 3, 1839; age 1y 6m 4d. (NW)
Infant son of ?G? & F.; still born Jan 17, 1843. (WC)
Elizabeth T., dau of A.J. & J.; d. Jan 7, 1849; age 1y 11m 9d. (WC)
Susan M.A., dau of G.W. & M.J.; d. Aug 17, 1849; age 10m 10. (WC)
John Lewis, son of A.J. & J.; d. Sep 4, 1849; age 4y 1m 23d. (WC)
Andrew J., son of A.J. & J.; d. Mar 4, 1850; age 10m 6d. (WC)
George B., son of A.J. & J.; d. Mar 11, 1857; age 10m 14d. (WC)
William S., son of A.J. & J.; d. Apr 25, 186--; age 2y 9m 20d. (WC)
Flora Jane, wife of Albert; d. Aug 26, 1881; age 29y 1m 25d. (SW)
Julia, wife of A.J.; d. May 13, 1896; age 68y 5m 28d. (SW)
A.J.; d. Jan 28, 1888; age 68y 3m 13d. (SW)
John D.; 1816 – 1901. (SW)
George L., son of J.D. & M.A.; d. Mar 30, 1865; age 27y 6m 28d. "1st Sgt Co A 16th IL Inf. (SW)
Margaret A., wife of John D.; d. Nov 3, 1869; age 51y 7m 19d. (SW)
Araminta E., dau of J.D. & M.A.; d. Mar 27, 1874; age 16y 6m (SW)
Leslie R., son of J.D. & A.J.; d. Oct 14, 1873; age 8m 22d. (SW)
Nancy J. (See CHAPLIN).

HALL:

Elisabeth Marion, dau of J.H. & C.A.; d. Feb 11, 1872; age 1y 2m 25d. (NW)
Jay Hamilton, son of J.H. & C.A.; d. Oct 11, 1871; age 2y 2m 15d. (NW)
S.M.; 1828 – 1904. (NW)
Martha; 1832 – 1900. (NW)
Livingston, son of S.M & M.; d. Oct 26, 1874; age 27d. (NW)
Joel; d. Dec 14, 1882; age 96y 9m 15d. (NC)
William H.; Sep 22, 1845 – Nov 7, 1921. (C)
Allie S., dau of W.H. & S.J.; d. Mar 11, 1892; age 20y (C)
Infant son of W.H. & S.J.; d. Jan 31, 1876. (C)
Fred C.; 1884 – 1947. (C)

HALL (Cont'd):

George; Jan 18, 1853 – Aug 8, 1919. (C)
Sarah J., wife of George; Oct 27, 1851 – May 5, 1924. (C)
Francis, dau of J.C. & S.A.; d. Jul ----, 1880; age ----. (NE)
Sarah A., wife of J.C.; d. Jan 12, 1888; age 68y 10m 17d. (NE)
John C.; d. Jan 10, 1891; age 78y 7m. (NE)
David D.; May 6, 1816 – Mar 16, 1901. (EC)
Cynthia A.; Feb 6, 1822 – Jun 22, 1906. (EC)
Mima; Dec 28, 1868 – Feb 14, 1889. (EC)
Tilla; Aug 25, 1868 – Jun 15, 1904. (NE)
Frank; 1862 – 1933. (NE)

HATCHET:

Sarah; 1854 – (no date of death shown). (NW)
Mattie; 1893 – 1917. (NW)

HEAD:

John H.; d. Mar 12, 1881; age 69y 3m 7d. (NW)
Charles O.; d. Dec 24, 1875; age 24y 2m 21d. (NW)
(The above 2 members of the Head family, along with Percy Goddard are noted on one large stone).
William B.; Apr 30, 1875 – Sep 1, 1907. (SC)
(Inscribed on top of stone, "B. of R.T.")
Thomas W.; 1818 – 1897. (SC)
Isabel P.; 1826 – 1921. (SC)
Henry; 1858 – 1937. (NC)
Eliza T.; 1858 – 1947. (NC)
William B.; Apr 26, 1821 – Feb 25, 1888. (NE)
Martha V. Miller; Aug 23, 1828 – Mar 23, 1899. (NE)
George F.; Feb 26, 1860 – Mar 24, 1895. (NE)
Lida c., wife of T.G.; 1850 – 1878. (EC)
Minnie E., wife of T.G.; 1860 – (no death date shown). (EC)
T.G.; 1847 – 1924. (EC)
Roy L., son of T.G. & M.E.; 1883 – 1895. (EC)

HENDERSON:

Clarence, son of R.N. & S.I.; d. Nov 30, 1873; age 9y 10. (WC)
R.N.; Chaplain, 112th IL Inf. (no dates shown). (WC)

(NOTE: Two additional stones are located in this immediate area; however, one is completely unreadable and the other appears to read "Leonard, son of ----", remainder of wording unreadable).

HICKMAN:

Jessie, dau of E. & T.; d. Mar 18, 1877; age ----. (NC)

HUMBARD (HUMBERD):

Thedocia E. (See ENGLISH)
Vernetta E., wife of W.A.; d. Oct 1, 1862; age 35y. (NC)
Herriett E., dau of W.A. & C.; d. Oct 18, 1865; age 9m 29d. (NC)
Margaret J., dau of A.S. & S.A.; d. Nov 22, 1857; age 4y 5m 27d. (NC)
Harriette, dau of A.S. & S.A.; d. Oct 23, 1857; age 2y 3m 11d. (NC)
Darcus, wife of S.; d. Jul 9, 1876; age 72y. (NC)
Sam; d. Jan 6,, 1858; age 59y 2m 7d. (NC)
Samuel H., son of W.A. & B.E.; d. Feb 2, 1857; age 2y 5m 10d. (NC)
Calvin M.; Feb 4, 1830 – Mar 22, 1870. (C)
Elizabeth S.; May 21, 1833 – Jan 9, 1902. (C)

JACOBY:

Ann, wife of A.; b. Feb 12, 1811; d. Dec 20, 1889. (NW)
Andrew; d. Jul 15, 1856; age 51y. (NW)

JAMES:

Mary A., wife of E. J.; d. Jun 25, 1887; age 31y. (C)

KEENER:

Emma A., dau of G. & C.; Aug 15, 1864 – Jul 12, 1896. (SC)

KIMBLE:

Ralph; Apr 1, 1888 – Dec 2, 1918. (SW)

KITCH:

Nathan; 1826 – 1908. (NE)
Nancy; 1836 – 1911. (NE)

LAIR:

Margaret; 1851 – 1917. (NE)
Thomas; Co A 5th KY Cav. (No dates). (NE)
Mathew; 1875 – 1956. (NE)

LITCHFIELD:

Rolla D.; 1894 – 1916. (NE)
Clara Frances; Nov 28, 1870 – Jan 31, 1940. (NE)
Richard M.; Mar 8, 1859 – Jul 6, 1940. (NE)

LONG:

C.L.; May 20, 1860 – Mar 22, 1888. (NE)
?Oshin?, son of ?A. L. & A.E.?; d. -----, ?1878?; age -----. (SC)

MC DONALD:

Clara A., wife of James W.; d. Apr 21, 1896; age 44y 22d. (NC)
Ruby Irene, dau of J.W. & C.A.; d. Apr 3, 1895; age 21d. (NC)

MC HENRY:

Edward D.; Sep 23, 1852 – Dec 6, 1890. (NE)

MC LEOD:

Hannah K., wife of J.W.H.; d. Sep 30, 1884; age 49y 20d. (NC)
John W.H.; d. Jan 1, 1886; age 48y 3m 5d. (NC)

MILLER:

James; 1853 – 19---. (EC)
Mary A.; 1856 – 1934. (EC)
Martha V. (See HEAD)

MOSS:

Sarah Briley; 1837 – 1913. (NE)
Clifford E.; 1904 – 1911. (NE)
Nora E.; 1881 – 1924. (NE)
Thomas J.; 1881 – 1956. (NE)

MURPHY:

Eva, dau of C.M. & M.J.; d. Jun 28, 1875; age 2m 25d. (NW)

OVERTON:

Colley, dau of J.B. & H.E.; d. Jan 14, 1862; age 11m 17d. (C)

PAINTER:

Marion Dale, son of F.M. & S.J.; d. Jan 29, 1861; age 1y 20d. (NE)
Jacob L.; d. May 15, 1877; age 35y. (NE)

POWELL:

Bertha, wife of T.A.; 1885 – 1920. (SE)

RALSTON:

Joseph; Dec 25, 1858 – May 7, 1878. (NC)
Nancy A.; Apr 8, 1841 – Jan 6, 1878. (NC)
Elma, infant dau of J.R. & N.A.; Dec 30, 1877 – Jan 2, 1878. (NC)

REYMER:

J.H.; Co I 124th IL Inf. No dates shown. (NW)

RUSH:

William H.; d. Aug 5, 1878; age 27y 6m 10d. (NE)

RUSSELL:

Elizabeth, dau of C. & L.; b. May 23, 1848; d. Apr 6, 1851. (NW)
Frank, son of C. & L.; d. Dec 17, ?1870?; age ----. (NW)
James E., son of L. & M.; d. Sep 6, 1864; age 1y 10m 27d. (NW)
Caswell; d. Nov 14, 1872; age 71y 3m 19d. (NW)
Lydia, wife of Caswell; d. Mar 30, 1872; age 58y 8m. (NW)
Absalom; d. Nov 15, 1869; age 38y 8m. (NW)
Sarah J., wife of Absalom; d. ----; age----. (NW)
William, son of c. & L.; b. Jan 2, 1836; d. Mar 24, 1839. (WC)

SALMON:

Bert; Feb 9, 1876 – Feb 5, 1896. (NE)

SHULTZ:

Hester A.; 1879 – 1934. (NE)
George W.; 1870 – 1937. (NE)

SCHULTZE:

August C.; Feb 26, 1861 – Dec 25, 1896. (C)
Henry; Aug 28, 1832 – Mar 18, 1895. (NE)
Henrietta; Mar 27, 1837 – No death date shown. (NE)

SELLERS:

Isaac; d. May 20, 1893; age 73y. (NE)

SHARP:

Grace M., dau of M.F. & S.--.; d. Jan 23, 1881; age 2m 4d. (NC)

SHELTON:

Elizabeth Spear, dau of George Spear & wife of S.C. Shelton; d. ?Sep 13, 1835?; age 19y 8m. (NC)

SHERHERD:

Lurena (See CAHILL)

SIMPSON:

Rachael J., wife of J.W.; d. May 6, 1878; age 36y 8m 4d. (NC)

SMITH:

Nellie B., dau of S.H. & M.E.; Feb 18, 1883 – Mar 31, 1883. (NC)
James R., son of S.H. & M.E.; Apr 24, 1885 – Aug 30, 1886. (NC)
Samuel H.; 1848 – 1931. (NC)
Mary E.; 1845 – 1929. (NC)

SOLOMON:

Anna L., wife of William; Oct 15, 1858 – Jul 20, 1900. (C)

SPAINHOUR:

Mary B., dau of A. & E.M.; d. Aug 10, 1871; age 1y 1m 11d. (NW)

SPEAR:

Elizabeth (See SHELTON)

STRICKLAND:

Isabelle, wife of E.; 1856 – 1902. (SC)

SWEENEY:

Louisa Champion; 1840 – 1921. (NE)

Irwin Oswald; 1878 – 1897. (NE)

SWINT:

Charlotte Alvira; d. May 7, 1901; age 74y 2d. (EC)

TEAFORD:

Eliza A.; d. Feb 24, 1871; age ----. (C)

Louis T.; d. May 24, 1873; age 26y 10m 1d. Co A 81st IN Inf. (C)

Charles, son of J.S. & Phebe; d. Oct 19, 1881; age 27y 6m 14d. (C)

Millie May, dau of A.W. & A.; d. Sep 4, 1879; age 1y 2m 15d. (C)

Infant dau of S. & S.E.; d. Oct 13, 1881. (C)

THOMPSON:

Joseph I.; 1867 – 1940. Inscribed on the stone, "He did his best". (NC)

Martha S.; Dec 9, 1832 – Feb 11, 1916. "Inscribed on the stone, "She hath done what she could." (NC)

John; d. May 5, 1889; age 91y 8m. (NC)

Samuel Berry, son of J. & M.S.; d. Feb 13, 1875; age 1y 3m 25d. (NC)

TIPTON:

Mary, dau of J. & W.; d. ----; age----. (NC)

Ella A., dau of J.W. & M.E.; d. Sep 8, 1878; age 21y 10m 28d. (NC)

A.; Apr 15, 1855 – Dec 3, 1882. (NC)

John W.; Oct 7, 1821 – Jun 8, 1913. (NC)

Margaret E. Deems; Oct 14, 1828 – Jan 18, 1916. (NC)

Emma R.; 1860 – 1934. (NC)

George W.; d. Feb 28, 1883; age 63y 10m 29d. (NE)

Asenath, wife of George W.; d. Mar 18, 1883. (See Genealogical Notes) (NE)

James M.; Feb 24, 18?43? – Apr 10, 1879; Co K 16th Inf. (NE)

Mary E.; Mar 4, 1849 – Mar 19, 1878. (NE)

Minnie R.; Oct 26, 1861 – Aug 16, 1880. (NE)

TOWLE:

Flora M., dau of D. H. & F.MM; May 27, 1904 – May 8, 1905. (EC)

TWICHELL:

Annie Marie, wife of William; b. Sep ?30?, 1805; d. ----, ---, 1852. (C)

William; d. Sep 25, 1864; age 66y. (C)

VEAL:

Jemima C., dau of A.J. & J.T.; d. Jan 22, 185--; age 4y 20d. (NW)

Isora, dau of A.J. & J.T.; d. Aug 5, 1863; age 1y. (WC)

VEF:

Lettie M., dau of A. & N.; May 20, 1892 – Oct 16, 1892. (NE)

WARREN:

Francis W.; d. Mar 10, 1865; age 34y 6m. (NW)

WILSON:

Robert E.; 1824 – 1911. (NE)

Margaret E.; 1823 – 1888. (NE)

Genealogical Notes – Spring Creek Cemetery

ATKINSON: Mary J. (Death notice, in part, from The Macomb Journal, May 10, 1883): “Mrs. Atkinson, of Astoria, Fulton Co., died April 30th; she was the daughter of Caswell Russell, deceased, who was a very early settler of Emmet Twp., this county.”

BLACK: Samuel H. was born in Clark Co. OH on Mar 19, 1826; son of James & Catherine Black, natives of VA. James Black, Sr. moved from VA to OH, farmed there till his death. In 1849, Samuel and his brother, James, Jr. rode horseback from OH to Chicago, thence to this county. James subsequently settled in Bushnell Twp. Samuel was a carpenter in the Macomb area for about 4 years, then returned to OH. Came back to this county about 1857 and bought a farm in Emmet Twp. and one in Sciota Twp. He later retired and moved to the town of Good Hope. On Dec 4, 1856, Samuel married Mary M. Bosler in Miami Co. OH. Mrs. Black was born in IN. The Blacks had 9 children – 4 died at an early age. Mr. Black served as Sciota Twp. assessor, Commissioner of Highways, Supervisor and School Trustee. Several members of the Black family were buried in Good Hope Cemetery. Isaac W. Black, Samuel and Mary’s eldest son, bought lot no. #190 in that cemetery’s 1st addition in 1903.

Samuel lived about 2 miles from Sciota. A daughter, Elizabeth, born in this county, married Dec 23, 1886, to Joseph D. Ruyan, a Bushnell Twp. farmer. He was a native of this county, born in 1862; Runyan’s had 4 children -- Edna, Stella, Winnie, and Clarence.

BLAND: 1850 census #200; Allen, 38, farmer, KY; Elizabeth, 37, KY; Samuel, 11, IL; Rachael, 8, IL; Mary E., 5, IL; Burnette, 2, female, IL.

Lottie Ruth Bland die at the home of her father, Joe Bland, in Emmet Twp. at 8:45 PM Sunday of diphtheria, following measles, after an illness of 3 wks, age 15y 10m 13d. Private funeral owing to nature of disease; interment in Sciota Cem. Born in Emmet Twp. Jun 10, 1895; survived by her father and 2 brothers, Silas and Hurley; both living at home; Bland lost 5 children and his wife died a year ago.

BONWELL: Telila (Death notice, in part, from The Macomb Journal, Feb 19, 1885): “Mrs. L. Bonwell, wife of James Bonwell, died at her home in Sciota on Feb 14th, aged 28 years. She is survived by her husband and 3 children, the youngest a baby of 9 weeks.”

BROWN: Dr. Ezra, physician and dealer in drugs, paints, and oil, in Sciota in 1878; on town school board and was a town trustee, elected in 1876. Dr. & Marilla (Death notice, in part, from The Macomb Eagle, Dec 4, 1880): “Dr. Brown died on the 30th, only a few hours after his wife. Mrs. Brown’s brother lives in Augusta, Hancock Co. She died on Sunday, the 28th. They were both buried in one grave on the 31st under the management of the Odd Fellows under which he was a member. They were both members of the Christian Church. They leave one child, a boy aged 10 years.”

BUGHMAN/BUCHMAN: The 2 infants, Flora & Geo. C. were children of John and Celia (Hainline) Bughman who were married in this county on Apr 7, 1842.

1850 census #358; Jacob, 38, farmer, OH; Celia, 38, KY; George, 7, IL; James, 5, IL; Adaline, 3, IL; John, 28, farmer, IL; Preston, 1, IL; George, 14, OH.

CHAMPION: Edward was born in Washington Co. KY; son of Thomas and Martha (Cannon) Champion, natives of VA. Married to Joanna Mitchell. She was a daughter of Daniel and Jane Berry Mitchell; Daniel born in SC; she a native of KY. Had 6 children. A son, Thomas M., moved to Emmet Twp. in 1856 and worked with his uncles, Mankin and Jacob, for several years. Later bought one the Champion farms. Thomas married Sadie Stickle in 1874. Mankin and Jacob were brothers of Edward.

Thomas M. Champion, brother of John D., Robt. M.; Mary M.; and Nancy J.; died at home in Emmet Twp. on Feb 11, 1907. Born in Washington Co. KY in 1836; moved here in 1856; married in 1875 to Sadie Stickle. Had 3 children – C.E. Champion; Eleanor Champion, both of Macomb; Mrs. Mattie Thomas of Griffith. Buried in Oakwood Cem; died of pneumonia.

*Robert Champion died Apr 25, 1880; age 1y 11m 9d; cause of death, poisoned, swallowed carbolic acid on evening of Apr 24; lived about 12 hours.

1850 census (see #217 SIMMONS) Simmons & Guy Cemeteries.

*Journal reported death, in Apr 1880, of a three-year-old daughter of John Champion, of Emmet Twp., from drinking carbolic acid.

CHAPLIN: Mary E. was a daughter of Gideon and Susan W. (Hainline) Chaplin who were married in this county on Oct 24, 1849.

CHARTER: Naomi; died Jun 26, 1878 at age 4m 9d of cholera; buried Head Cemetery.

1850 census #284; Bowen G., 25, farmer, KY; Polly J., 25, KY; William J., 4, IL; Nancy F., 2, IL; May A., 1, IL; Ann, 54, VA; John B., 35, TN.

CLARK/CLARKE: Wm. B. Clarke, son of James & Polly "Mary" Lewis Clarke; eldest of 10; born in Washington Co. KY Mar 31, 1819; Clarke's moved to Cass Co. IL in 1829; was there a year; in 1830 moved to this county and settled in Chalmers Twp.; 2 miles south of Macomb; 2 years later moved to Macomb & James died there in 1877; widow lived till 1881. In 1850 settled in Emmet Twp.; moved to section 29, Sciota Twp. in 1854; began farming on site of the town of Sciota; died at that place. JP of Emmet & Sciota Twp.s for 43 years; married Nov 15, 1848 to Emma Jacoby, native of PA; had 7 children – Henry, living in King City, MO; Mrs. Alice McHenry of Rising City, NE; Mrs. Jemima McHenry of Rising City, NE; John of Rice Patch, NV; Wm. & Samuel, living in the mountainous region (western US); Eva Marrs, wife of Dr. R.F. Marrs of Sciota. Mrs. Clarke died Jul 15, 1867; Clarke then married Mrs. Rebecca E. Hainline (nee Bugg) on Mar 7, 1878; she survives; Wm. B. Clark died at noon at his home in Sciota on May 26th, 1898 at age 80; Henry here for funeral and will return to MO shortly; Mrs. Marrs and her two daughters, Jemima & Helen will visit Henry at his home for about 2 months. Clarke donated land to the TP&W RR and a town was later built on this property & called Clarksville, later changed to Sciota. J.C. Clarke, son of Wm., first child born in Sciota Twp. on Feb 22, 1855.

James Clarke; born in Lincoln Co. KY Sep 26, 1797; parents were John and Ann (Whitten) Clarke; father a soldier of Rev. War; family moved to Washington Co. KY when James was small; James married on May 21, 1818 to Mary Lewis in Washington Co. KY; married to her for 58 years; until his death; had 11 children --- 8 boys and 3 girls; the girls and the oldest son living in 1885; others died previously; moved with his family to Morgan Co. IL in 1829; to this county in Spring of 1830; when he moved here Elias McFadden, living on the Hunter farm south of Macomb & John Baker, were the only area residents; Clarke lived till his death on Jun 12, 1876, near Macomb.

CLARK/CLARKE (Cont'd): Samuel L., moved with his father, James, from KY to this county in the spring of 1830; settled on section 36, Emmet Twp.; Samuel with parents until his marriage in 1853 to Nancy A. Hardin; had 4 children --- David H.; James D.; Clara; and Samuel L.; Samuel born Sep 29, 1822 in KY; parents were James & Mary (Lewis) Clarke; he died Feb 8, 1863 and was buried in the Russell Cemetery (Russell Cemetery – Spring Creek).

After the death of Samuel, Nancy Ann Hardin Clark married Mr. Calvert and lived in Emmet Twp. several years; Calvert died about 1907 and Nancy Hardin Clark-Calvert moved to Colorado and lived with her son, Jesse Calvert; she then went to the home of her daughter, Mrs. Bradley in Delta, CO where she died in Jan 1913 at age 80y. Surviving members of the Clarke marriage included Davis H. of Regina, Canada. Another son, Lewis (brother of Davis) died at St. Elmo a few days, before his mother, Nancy & Davis was at that location attending his brother's funeral when he learned of his mother's death in CO. Davis' wife remained here and visited with her parents Mr. & Mrs. J.W. Russell.

Davis Clarke's wife was Melinda Russell; born Emmet Twp. They had 2 children --- Myrtle (Mrs. M.M. Burkhart) of Sciota and James W. Davis and Melinda Russell were married Dec 16, 1875.

Benj. F. Clarke and Louisa Mayfield married in this county on Feb 22, 1844; after the death of his first wife in 1846, Benj. married Nov 1847 to Mary Jane McGinnis.

1850 census #198; Franklin, 28, farmer, KY (Benj. Franklin Clarke); Mary J., 25, TN; Mary E., 6, IL; Virginia, 7 mos., IL; Thomas MC GINNIS, 11, IL.

DUNCAN: Peter C., d. Oct 25, 1921; age 74y 1m 12d; was the youngest son of Smith & Mary Ann (Carter) Duncan, natives of KY who moved to the Spring Creek area from KY when Peter was about 5 or 6 years old. Peter lived his entire life in this area. He was the last pupil of the old log Timber School. He never married; was known throughout the area as "Uncle Peter Duncan"; died at his home in Sciota.

John B. Duncan; Sciota Town Trustee --- elected in 1876; named treasurer.

FERGUSON: Wm & Ellen (Sandusky) Ferguson both died in this county; a daughter, Polly, married on Jul 5, 1868 to Charles F. Johnson; Polly, born in this Twp. 1850 census #207; William, 52, gunsmith, KY; Ellen, 41, KY; R.A., 18, male, farmer, KY; Ruth M.W., 14, KY; Harry, 10, IL; Isabel, 8, IL; Polly, 6, IL; Cynthia, 4, IL; William, 2, IL; James ISOM, 18, gunsmith, IL.

FERINGTON: Orsemus; veteran of Black Hawk War (May 1832).

FOLEY: Lester (Death notice, in part, from The Macomb Journal, Feb 10, 1881): "The little son of Theodore and Celia Foley of Emmet Twp. died Friday, age 4 years. He was an only child since they lost another child 2-3 years ago."

GLEASON: Myrtle Belle Gleason was born at Gillett, Arkansas Jul 13, 1895. Died on Jun 22, 1906, being at the time of her death 10 years, 11 months and 10 days. She was brought by her parents, Mr. & Mrs. John Gleason, to Sciota, IL a few years ago; was a member of the Baptist Sunday school and a pupil in the public school here. She leaves to mourn their loss, her parents, 2 brothers and 2 sisters; Roy, Pearl, Mary, and Charley. Cause of death, spinal meningitis. Those relatives from a distance were Mr. & Mrs. Peter Greenlief, grandparents of the deceased, and Mr. & Mrs. Frank Greenlief, uncle and aunt, all of Birmingham, IL. Funeral services held at the home in the west part of town on Saturday, Jun 24th. Burial in Spring Creek Cemetery.

GOODMAN: 1850 census #215; John, 25, blacksmith, KY; Sally, 28, KY. John A. residence in Clarksville in 1870; born in KY; moved here in 1833.

Mary E.; d. Jul 4, 1880; age 25y 9m 11d; married; born this county; died of TB, Good Hope; buried Humberd Cemetery.

GRAHAM: Henry Harrison, son of Wm. & Elizabeth (Jackson) Graham, natives of Marion Co. KY. Graham family later moved to Fulton Co. IL in 1835 and Henry born there on Apr 23, 1836. Henry farmed in Warren Co. from 1862 – 1865; then bought 80A near Good Hope and lived there about 10 years; after death of his wife, Henry moved to another farm in Macomb Twp. In Sep 1862, Henry married Mary Dry, a native of PA. They had 5 children.

GRAVES: Felix J.; son of Henry and Sarah (Camden) Graves; worked in Macomb factories; died in Macomb of a lung ailment; married. Henry was born in KY; Sarah Katherine Camden Graves was born in KY also.

Bennie G.; veteran of US Navy; professional boxer; single, never married; died in CA; cremated there and urn returned to this county.

GRILLS: William P.; died Jun 16, 1881 in Emmet Twp. of hemaphegia; age 50y 8m 5d; married; farmer; born in TN; buried in Head Cem; resident of IL 25 years.

Thomas R. and Ruth Strickland were married in March of 1881.

(Macomb Journal, Oct 18, 1883): "James Grills died at Denver CO recently and was buried by the side of his father in the Clark Graveyard in Emmet Twp.; his mother survives." Was a son of Wm. & Mary Grills. No stone.

HAINLINE: Joseph H. (Obit, in part, from The Macomb Journal, Jan 26, 1882): "Joseph Hardin Hainline died at his residence in Sciota Twp. on Jan 14th, aged 45 years. Born in Sciota Twp.; parents moved from KY to Sciota 46 years ago. The deceased was their first child born after coming to Illinois and the first white child born in Sciota Twp. He served with Co I 124th IL Inf in the Civil War. In 1868, he married Miss Virginia A., daughter of James D. Griffith of Emmet Twp. They had 4 children; 3 boys and a girl, all of whom survive along with the wife....."

Virginia A.; daughter of James D. and Nancy A. (Gillan) Griffith. James moved to this county in 1853 & settled on section 7; bought 250A of John Gash and 70A on section 8; later owned about 110A in Lamoine Twp. frame for family home was sawed on his own mill & other lumber bought in Chicago; James D. was raised in VA; born there in Jul 20, 1810 at Buckingham; he walked to Highland Co. OH in 1829; worked on OH canal for 3 years & farmed there till 1853; moved here then. Married in 1833 to Nancy A. Gillan, a native of VA and daughter of Wm. Gillan, a veteran of the War of 1812; Mrs. Gillan later moved to this county & lived with her dau, Mrs. Griffith, till her death in Jan 1880; James' father died in VA & his mother died in OH; Griffith's children were; Mary J., later the widow of David Newell of Emmet Twp; Benj. A. lived in Sciota Twp.; Henry C., lived in Blandinsville; James M. & Cary both lived in Emmet; Virginia A., later the widow of Joseph Hainline & lived in Sciota; Wm. C. lived in Hire Twp.; John A. died; Clara E.; Isaac W. (name probably wrong as history states this was wife of Samuel Reister of Walnut Grove Twp.); David was born in this county & married on Oct 14, 1877 to Nannie Wooten, a native of KY; had 1 child – Winifred M.; James D. had 3 sons in the Civil War; Benjamin; James M.; & Cary. All three wounded but not seriously. (See Walker Cemetery for other members of Griffith family).

HAINLINE (Cont'd): John Dunford Hainline lived on sec 6, Emmet Twp. many years; his parents were George & Flora Cockerel Hainline; his father was born in Fayette Co. KY; mother in TN & raised in Fayette Co. KY: John D. was born in Montgomery Co. KY on Sep 7, 1816; married in 1836 to Margaret Ann Douthit and 2 years later moved to this county and settled in Emmet Twp.; had 11 children --- 8 living in 1885; George L. was killed at Bentonville, NC late in the Civil War; James Lewis Hainline, a nephew who was raised by John D., was wounded at Bentonville & died in MO in 1866; Margaret Ann died Nov 3, 1869 and a year later Hainline married Amanda J. Purdy; both living in 1885; John bought 100A for \$700 when he arrived in this Twp.; adjoining land later was bought for about \$10 per acre; he had 2 sons in the Civil War, George & Wm.H.

George; born in KY; son of John Hainline who migrated to KY from NC & settled near present site of Lexington along with Daniel Boone.

Flora P. Cockerel, wife of George; aunt of a former U.S. Senator from MO --- Cockerel.

John Hainline & family moved to Sciota Twp. in Oct 1836 & settled sec 31 (SE¼): there till death on Jun 28, 1861; born in Montgomery Co. KY Mar 14, 1796; married Mar 1826 to Mary Devery of Clarke Co. KY; had 10 children --- David T.; Susan W.; Mary D.; Henry C.; Thomas S.; John, died' Joseph H.; Nancy E. Baxter; Sarah I; & John W. In 1840, John built a house on SW¼ of sec 31 & a son, John W. lived there in 1885.

John W. Hainline, the 10th child of John & Mary (Devery) Hainline, born May 10, 1846 & lived in Sciota Twp. entire life; married in Oct, 18---, to Catherine James, native of OH; had 7 children --- Chas. H.; Laurence; Fred; Effie J.; Wilmer M.; Frank. Hainline owned 155A in 1885.

Susan M.A., was a daughter of George W. and Mary Jane (Keithley) Hainline who were married in this county on Jun 19, 1846?.

George W., lived on sec 2, Hire Twp.; born Jun 3, 1825 in Montgomery Co. KY; son of George & Flora (Cockerel) Hainline; to this county in 1838; at home till marriage on Jun 16, 1845? to Mary Jane Keithley born Jul 1826 in IN; she a dau of Jacob Keithley former owner of Hainline farm; had 14 children --- Nathan T. born Oct 17, 1847; Susan Mary A., born Oct 7, 1848; George T. born Jan 12, 1850; Sarah L. born Sep 5, 1851; Flora A. born Nov 4, 1852; John born Mar 25, 1854; Francis M. born Mar 20, 1855; Jacob E. born Nov 16, 1856; Seth born Sep 1, 1858; James O. born Feb 19, 1860; Anabel born Dec 27, 1861; Americus G. born Jan 2, 1862; Wm. S. born Dec 29, 1865; Ida M. born Oct 24, 1869. Susan died Aug 10, 1849; Flora died Feb 14, 1876; John died Oct 18, 1854.

Thomas Hainline married Jane Bice, dau of James and Frances (Aukrom) Bice.

Wm. T. Hainline born in Emmet Twp. Jul 29, 1841; parents were John D. & Margaret A. Hainline; worked with father on farm till age 18; then went to Pike's Peak on gold rush; there 3 weeks & returned; farmed till Civil War; enlisted Apr 19, 1861; re-enlisted at end of 3 years & discharged on Jul 8, 1865; taken prisoner at battle of Peach Tree Creek (Atlanta) on Jul 20, 1864; in pen at Andersonville; there 2 mos; returned home after the war; elected county treasurer; bought drug store of P.H. Delaney and ran it till fall of 1869; married Jun 12, 1866 to Vicoria Schleich of Fulton Co.; had 3 children --- 1 died in infancy; Maud S. born Sep 29, 1869; Millie D. born Jun 1, 1872. Mrs. Hainline died Feb 24, 1874; Wm. bought half interest in Macomb Journal, bought out partner in Feb 1881 and become sole editor; married Catherine L. Voorhees on Jan 24, 1879; had a child --- Jean L. born Jun 30, 1883.

Andrew J.B. (1853-1867) was a son of Thos. S. & Lucy Ann (Charter) Hainline who were married in this county on Feb 21, 1850.

HAINLINE (Cont'd): Jacob Hainline native of KY; moved to Hire Twp. in ----; farmed 320A on sec 17, built cabin on NW and lived there till death in 1865; buried in cemetery just south of Blandinsville; born in Montgomery Co. KY in 1789; married Celia Cockerel, native of KY; had 8 children --- 5 living in 1885; Celia moved in with children after Jacob died.

T.S. Hainline; 1870 residence on sec 15, Hire Twp.; farmer; born in KY; moved here from KY in 1838.

Flora Jane (Obit, in part, from The Macomb Journal, Sep 1, 1881): "Flora J. Hainline died in Emmet Twp. on Aug 26, aged 29 years 1 month and 26 days. The daughter of A.J. and Julia Hainline; born in Emmet Twp. on Jul 1, 1852; married Albert Hainline last fall; survived by her husband and an infant child, parents, brothers & sisters...."

A.J. (Obit, in part, from The Macomb Journal, Feb 2, 1888): "Andrew J. Hainline of Emmet Twp. died at his home on Jan 20th, aged 70years. He was born in Montgomery Co. KY in 1818 and lived there until 1838 when, with his parents and uncles' large family, he came to Emmet Twp. where he has since resided. In 1844, he returned to KY and married Miss Julia Douthitt. They returned to this county in November of that year. He had 10 children, 5 of whom survive along with the widow. The funeral was Saturday with burial in the Humbert Graveyard beside the 5 children who preceded him in death. A daughter of Mr. Hainline is Mrs. Eliza Griffith of western Kansas.?"

HALL: Joel (Death notice, in part, from The Macomb Journal, Nov 17, 1881): (NOTE: Stone inscription differs from information obtained thru news items). "Joel Hall, an old citizen of McDonough Co. died at the residence of his daughter, Mrs. Bond in Blandinsville Twp. on Tuesday, Nov 15, 1881; aged 92 years. He was buried yesterday in the Spring Creek burial ground in Emmet Twp."

Viola J.; d. Feb 6, 1880; age 8y 14d; b. Knox Co. IL; d. of diphtheria at Sciota.

Francis Matilda; died Jul 18, 1880; age 27y 5m 8d; single; hair dresser; died in Good Hope of peritonitis; born in this county; buried in Humbert Graveyard.

(Obit, in part): "Mrs. Cynthia Willis Hall, wife of David Hall, a pioneer resident of this county, died Jun 22, 1906 at 3:00 AM at her daughter's home, Mrs. Samantha Roberts of Sciota. Interment will be in the cemetery south of Sciota. Deceased had been in failing health since early last winter; heart trouble. Stricken Sunday afternoon with a paralysis and never recovered. Born in KY Feb 6, 1822, being 84y 4m 16d old at the time of her death. Came to Illinois as a small child with her parents. Married about 60 years ago to David Hall, who died about 5 years Sciota 30 -35 years ago. Moved to Sciota later; left following children --- W.H. and Frank; Mrs. Samantha Roberts all of Sciota; Cornelius of Macomb; George of Keokuk, Iowa; Charles of San Francisco & Mrs. Hattie Stodgell of St. Marys. Two daughters preceded her in death..... Davie married Cynthia Willis in Mar 1838 in this county. David owned and operated a meat market on Douglas St. in Sciota in 1878.

Sarah A. (Obit, in part, from The Macomb Journal, Jan 12, 1888): "Mrs. Ann, wife of John Hall, for years a resident of Sciota, but more recently of Blandinsville, died today. She was among the pioneers of this county and was the sister of Mrs. Lois Leach of Macomb. She was the daughter of James & Ruth Sarles and was born in Clark Co. IN on Feb 19, 1819. With the family of sisters, Mrs. Harriet Spangler (who now lived in MO) and another sister, Mrs. Lois Leach of Macomb, she came to IL in 1838, settling in this county, where she has since resided, except for a year or two in MO. She was married in this county on Jan 29, 1839, to John C. Hall; he survives along with 5 daughters and 2 sons. They had 10 children, but 2 daughters and a son are now deceased.... The funeral was at Blandinsville with burial in the Humbert or Spring Creek Cemetery."

HALL (Cont'd): S.M.; 1870 residence sec 29, Sciota Twp.; farmer; born in KY; moved here in 1839 from KY; school director in Sciota in 1878.

1850 census #206; John C., 36, farmer, KY; Sarah A., 31, IN; James H., 9, IL; Mary E., 5, IL; Emeline, 3, IL; Usal, 5 mos., IL.

1850 census #213; Joel, 58, farmer, VA; May, 47, KY; Stit_h M., 22, farmer, KY; Elizabeth, 18, KY; Cynthia, 10, KY; Elizabeth, 12, KY; William DUNWOODY, 17, farmer, IL; Alexander DUNWOODY, 10, IL.

HATCHET: Mattie Hatchet, a dau of Mrs. Sarah Hatchet, of Sciota, was an attendant at the Bartonville Sanitarium. Miss Hatchet was seriously ill in Oct 1917 and her mother was called to that town because of that illness in early Oct. (Obit, in part): "Miss Martha Hatchet, formerly a Phelps Hospital nurse in Macomb, died at 4:30 Oct 15, 1917 at a Bartonville Hospital where she worked as a nurse. Death due to typhoid fever. Born in Willisburg, KY, Aug 9, 1893; age at death 24y 2m 6d. Youngest child of Edward B. and Sarah Hatchet. Her father died and the family moved to this area and settled near Sciota in 1904. Surviving were her mother, a brother Harrison of Rushville; 3 sisters, Mrs. Edna Breeding of Canton, Mrs. Bessie Seamons of Sciota, and Mrs. Maggie Wayman of Versailles."

HEAD: John H. (Death notice, in part, from The Macomb Journal, Mar 17, 1881): "John Harrison Head died at Sciota Twp. last Friday; born 1812, in Washington Co. KY, son of James and Ibbie Head, who were early settlers in McDonough Co. Mr. Head's son, Charles, died on Christmas Eve in 1875." J. H. Head settled on sec 32 in 1843 and lived there till death in Mar 1881; moved here with parents in 1832 and settled first in Emmet Twp.

James; father of Thomas, Maria , and Wm. B.; native of VA; moved to KY at an early age and to Emmet Twp in 1832; settled SW of Sciota on sec 5; there till 1855 when moved to Macomb; died there Mar 2, 1863; raised 12 children; only 3 living in this county in 1885 (above named). Maria married Jefferson Hays.

James D. Head (father of Thomas) and 2 children of Thos. W. and Isabel are buried in Head Graveyard.

Thomas W.; moved to this county 1832 with parents; lived in Emmet Twp. till Mar 1848 & moved to Sciota; settled on sec 32; owned same farm in 1885 but lived in town of Sciota; 2 sons had grocery business here & at Good Hope. Isabel; her father was Tobias C. Painter, buried in Stickle Cemetery.

James C. Head and Sarah A. Anderson married; license issued Dec 29, 1834. J.C. Head; Mormon War Vet.

William B. (Obit, in part, from The Macomb Journal, Mar 1, 1888): "Wm. B. Head was buried in the Head Cemetery on the farm of his father on Tuesday. Nearly all of the family is buried there. He was the son of James & Isable Head and was born in Washington Co. KY. As a youth, he came to IL with his parents and a large family of brothers and sisters, arriving in Emmet Twp. on Christmas Day, 1832. He married Miss Miller & afterwards lived in the same neighborhood until about the time of the Civil War. Then he moved to Mississippi for several years. He returned & lived in Emmet & Sciota Twps. until 2 years ago when he moved to Iowa where he was living when he died. He as the father of 17 children and was the brother of Thos. Head of Sciota." Wm. B. and Martha V. Miller were married in this county on Dec 26, 1844.

H.S.; 1870 residence, sec 29, Emmet Twp.; farmer, b. KY; moved here in 1831 from KY.

John M. Head born Aug 18, 1855; farmed till joining brother in business in 1882; married Dec 23, 1880 to Jessie Gutick, native of Beardtown; had a dau, Della K.

HEAD (Cont'd): Charles O. (Notes from Chron. of Co. 1870-1881). Charles O. Head killed in Sciota in Dec 1875, by Albert Head. News reported in Apr 1878 that the trial of Albert Head had been concluded in Macomb; Albert was charged with the killing of his cousin in 1875; he was acquitted.

Albert Head, partner with brother, Joseph M.; opened business in Sciota in 1882 (Apr); grocer, etc; born Jan 14, 1849 in this county; father was Thomas W.; Albert lived entire life in this county; married May 10, 1872 to Maggie Perrine, native of Henderson Co.; had one child --- Ora A.

Wm. T. Head, Co. Circuit Clerk; born in Washington Co. KY on Feb 16, 1816; moved here in 1834; was recorder, sheriff, circuit clerk, etc.; moved to Sabine Co. MO. in 1867 & there till Jan 1874; was mayor of Marshall MO; moved to Quincy in 1874; circuit Clerk of Adams Co.; living there in 1885.

1850 census #232; William b., 26, farmer, KY; Martha, 20, Va; Thos., 4, IL; Robert, 3, IL; Jefferson, 2, IL; Mary E., 2mos. IL.

#233, Thomas, 31, KY; Elizabeth, 24, PA; Tobias, 3, IL; James, 1, IL

#234, Harrison, 39, KY; (John Harrison); Susan, 36, PA; James, 5, IL; Martin, 4, IL.

Licensed to wed: Jul 1898, Ben E. Head, 35, Sciota; Alice Litchfield, 21, Sciota.

HENDERSON: R.N.; physician & surgeon in Sciota in 1878; Sciota town clerck – elected in March 1870; entered service Sep 1862 in Peoria; discharged Jul 1865 in Chicago.

HICKMAN: Jessie, dau of Eliphalet and Tacy (Wilkinson) Hickman; Eliphalet moved to this county in 1861 and settled on sec 4, Emmet Twp.; bought 230A and later owned 305A in this area; lived on the SW¼ of sec 4; a native of IN & born in Floyd Co. IN on Mar 13, 1831; parents were James and Elizabeth (Sisloff) Hickman, both natives of NC; they both died in VA; in 1862; Eliphalet went to IN & enlisted in the army on Aug 12, 1862 in Co A 81st In Inf; in service 6 months & discharged due to illness; returned to New Albany, IN & then returned to this Co.; married on Feb 3, 1864 to Tacy Wilkinson; other children were – Elizabeth J., wife of Partick Hickman, lived in Emmet; Ruby A.; Lillie May; Ella; Charles L.; Onie; Frederick E. and Grace.

HUMBERD / HUMBARD: William Humerd died at the county farm at 8:30 o'clock AM, Jan 14, 1899 of heart trouble. He resided at Sciota for a long time, going to the county farm last summer. He was married several times and was the father of a large family. Deceased had been complaining for several days. He was 76 years old. Funeral services were held in Sciota, after which the remains were laid to rest in the cemetery at that place.

Wm. A. married Bernetta (?Vernetta?) Elizabeth Drane in this county on Feb 10, 1847.

David B., Humberd died at 4:15 PM May 28, 1918, of cancer. Burial in Spring Creek Cemetery.

1850 census #209; Samuel, 51, farmer, TN; Sarah, 24, TN; Ellen, 20, TN; Adan, 17, farmer, TN; Harriett, 13, IL; Andrew J., 11, IL; John H., 6, IL

JAMES: Mary A. (Death notice, in part, from The Macomb Journal, Jul 7, 1887): "Mrs. M. James, living a few miles southwest of Sciota, died last week, leaving 2 small children." Aged 31y 2m 2d; born in IA; resident of this county 25y.

LAIR: Thomas Lair, Sciota, died Apr 28, 1918 at 11:00 PM of complications due to advanced age. He was 84 years, 9 months and 16 days old. Burial in Spring Creek Cemetery. Son of Herbert & Judith Lair, born in Washington Co. KY Jun 12, 1833 & moved to Emmet Twp. in Sep 1897. Moved to Sciota in 1898. Margaret Graves, sister to Henry Wood Graves, who survives. Had 9 children --- 3 living, Matthew of Sciota; Andrew of Macomb; and Mester Schultz of Sciota. Civil War veteran; member of the Christian Church. Deceased children were Laura, Maggie, Alice, Walter, James, and William. Matthew; never married

LONG: C.L. (Charles Luther) (Death notice, in part, from The Macomb Journal, Mar 29, 1888): "Luther Long, collector of Sciota Twp., die at his home in Sciota last Thursday, the 22nd, aged 27 years." Aged 27y 10m 2d; born LaCrosse, IL; married; farmer; died of TB; buried in Humbert Graveyard.

JACOBY: 1850 census #222; Andrew, 44, farmer, PA; Ann, 39, PA; Martha, 18, PA; James, 16, farmer, PA; Joseph, 9, PA; Elija, 7, IL; Amanda, 6 mos., IL.

MC HENRY: Elizabeth McHenry died in Sciota Feb 23, 1898 at age 85 years, 5 months and 12 days. Buried beside her husband at the cemetery south of town. Born Sep 11, 1812, member of the Christian Church about 35 years; had 14 children, 8 sons and 6 daughters; surviving children are Wm. of Danbury, NE; Martha, of Sciota; James Eli; W. Virginia; Jerry, Aledo; Robert, address unknown; Dee, Rising City, NE; Maggie Butler, Jamaica, IA; Ann Dowley, Danbury, NE; Mary Murphy, Sciota; Emma Boals, Phelps Staton; George, Sciota.

MC LEOD: Hannah K. (Death notice, in part, from The Macomb Journal, Oct 23, 1884): "Mrs. Hannah, wife of John McLeod, died Sep 30th. Her maiden name was Knappenberger. She was born in Westmoreland Co. PA and came to IL in 1855 where she married John McLeod on Jan 16, 1876. She was a member of the Lutheran Church and later of the M.E. Church at Maple Grove.... She is survived by her husband, and aged mother, 7 borthers and 4 sisters...."

John W.H. (Obit, in part, from The Macomb Journal, Jan 7, 1886): "John McLeod of Emmet Twp. died last Friday; he was born not far from Winchester, Frederick Co. VA, and was aged 49 years. He came to Emmet Twp. in Illinois just before the war. During the war, his sister, whose husband was in the southern army, died at Columbia, MO. John, though unmarried, took care of her family of orphan girl, bringing them to Illinois and caring for them until after the war, when their father returned. This southern officer married another sister of Mr. McLeod; she is now Mrs. Kneisly. When about 40 years old, he married Miss Hannah Knappenberger. They did not have any children. She died last September. He is also survived by a brother, Wm. C. McLeod, and a sister in Page Co. VA."

MOSS: Mrs Sarah A. Moss died about 3:00 AM today at the home of her son, T.J. Moss, in Sciota, of paralysis and complications from which she had suffered for several months; age 73y 5m 7d; funeral services Sunday from the Methodist Church in Sciota; interment in the cemetery south of town; deceased was born Sep 16, 1838 in KY; married at Carthage, IL, to Samuel H. Moss, Jul 14, 1856; after marriage they moved to near Colchester; resided there till 1890; moved to southern IL; then moved to MO; lived there four years, and then moved to Sciota. Her husband died Apr 14, 1911. She leaves the following children; John, Astoria; Mrs. Sarah Ann Kennett, Memphis, MO; Oliver R., Newells MO; Mrs. Mary B. Metcalf, Blandinsville; J.C., Kimball, NE; A.E., Kimball, NE; Thomas J., Sciota.

MURPHY: Eva Hamilton; d. Jun 28, 1880; b. & d. Sciota.

PAINTER: Jacob L.; youngest son of Tobias George & Catherine Painter; born in Emmet Twp.; father, Tobias G., born in Westmoreland Co. PA in Dec 1798 & married Catherine Painter; moved to IL about 1830; first settled near Beardstown and later moved to the Spring Creek area of Emmet Twp. T.G. died May 29, 1870 and was buried in Stickle Cemetery. Jacob's sister, Isabel, married Thomas W. Head; both buried in this cemetery.

Marion Dale; son of Francis Marion Painter and grandson of Tobias George and Catherine (Painter) Painter.

1850 census #212 (See Stickle Cemetery).

PATTENT: 1850 census #195 (CHAPLIN): Franklin Pattent, 35, farmer, NY; Harriet, 37, NY; Aaron, 13, NY; Charles, 11, NY; Betsey, 9, NY; John, 7, NY; Daniel, 5, NY; Joseph, 3, NY; Gilheen CHAPLIN, 29, male, farmer, NY>

POWELL: Bertha; dau of Henry and Sarah (Camden) Graves; married T. Arthur Powell; a dau, Dorothy, lived in Bloomington, IL; Mr. Powell buried in Blandinsville.

ROBERTS: The infant son of Mr. & Mrs. Allen Roberts of Sciota died last week and was buried in the cemetery south of town.

RUSH: William Harrison; died Aug 5, 1878; age 27y 6m 10d; farmer; married; moved here in 1859 from Perry Co. OH; died of cholera.

RUSSELL: Caswell Russell, oldest inhabitant of the county, died in Nov 1872; settled in Emmet Twp. in 1828. Also in Mar 1872 Lydia Russell, on of the first pioneers of the county died. 1850 census #230; Caswell, 52, farmer, TN; Lyda, 36, KY; Abner, 19, IL; Margaret, 18, IL; Julia A., 16, IL; George, 12, IL; John M., 11, IL; Lewis, 8, IL; Edward, 5, IL; Elizabeth, 2, IL.

SCHULTZ: August; died Dec 25, 1896; laborer; married; suicide by hanging; south of Sciota.

SELLERS: Isaac Sellers married to Cornelia Wilson, dau of John O.C. and Adeline (Purdy) Wilson; he, John, was first Mayor of Macomb; Wilson died in 1880; after Sellers died, Cornelia returned to live with her mother.

SHARON: Mr. & Mrs. Richard ?Sharon? of Cuba; cares for his parents graves at Spring Creek each spring. Visited in Sciota with Mr. & Mrs. Ross Hott.

SHELTON: After death of Ellizabeth (Spear) Shelton in 1835, Sebert C. Shelton was licensed to marry Mrs. Elizabeth Duncan in this Co. in Mar, 1838. No marriage is on record. On Feb 3, 1839, Mr. Shelton married Elizabeth Bonham.

SIMPSON: Rachel Jane; died May 6, 1878; age 36y 9m 4d; rheumatism & TB; born in this county; married; buried Spring Creek Cem.

SHRYACK: Jessie; d. Mar 2, 1882; age 1y 7m 18d; b. Emmet Twp. d. Sciota.

STRICKLAND: Elisha of near Youngstown, IL died at 2:00 PM, Mar 8, 1913 of anemia; ill about a year; in hospital at Marietta-Phelps 8 weeks & died there; was 57y 1m 14d. Funeral at Sciota. Born Jan 22, 1856 near Sciota; lived there several years; moved to Macomb then to Youngstown. Married in 1879 to Isabelle Head of near Sciota. Surviving children were: Mrs. Ida Ferris, Swan Creek; Mrs. Inez Hall, Avon; Fran, Melhose, IA; Nora, at home. A brother, James, and a sister, Mrs. Chas. McGrew, Seward, NE. His parents were Isaac and Rebecca (Cromer) Strickland. They married in IN in 1855 & then moved to IL.

SWEENEY: Louisa Champion (Probable wife of William Oswald Sweeney): he a Civil War Vet; died in 1919 & buried in Walker Cem. Also a daughter of William & Louisa Sweeney in Walker Cem.; she died in 1877 at age 1y. (Several other members of the Sweeney family at Walker Cemetery).

TEAFORD: Taylor Teaford, a grain buyer of Sciota, died suddenly from over exertion in May 1873. (Louis T. Teaford).

Nelia May; died Sep 4, 1879 at age 1y 2m 15d; born Emmet Twp.; died of bronchitis; buried Humberd Graveyard.

TIPTON: A. (Death notice, in part, from The Macomb Journal, Dec 7, 1882): "Albert Tipton of Sciota Twp. died at the residence of John W. Tipton, his father, in Sciota, on Dec 3rd, age 27y 8m 15d." Albert operated boot store in Sciota; business established by his father, John W. in Oct 1881; after Albert's death, John W. took over. A. Tipton ran grocery store in Sciota in 1878.

John; Sciota carpenter & builder in 1878. John W. Tipton listed as president of Sciota Village Trustees in election of 1870.

Ella Ellen; died Sep 8, 1877; age 21y 11m 29d; dau of a lawyer; single; born in Prairie City Twp.; died of TB; buried in Emmet Twp.

George W. (Death notice, in part, from The Macomb Journal, Apr 12, 1883): "G.W. Tipton died on Feb 28th at his residence in Prairie City. He was born in Baltimore Co. MD on Mar 29, 1819 and was aged 63y 10m 29d. His wife died shortly after him; he is survived by 5 children."

Asenath (Death notice, in part, from The Macomb Journal, Apr 12, 1883): "Asenath, wife of G.W. Tipton, died Mar 5th at her home in Prairie City. She was born in Perry Co. OH on Mar 20, 1824; her maiden name was Skinner. The funeral was Mar 6th at Sciota...."

TWICHELL: William; member of McDonough Co unit in battle of Shiloh, Apr 6, 1862; lived in Emmet Twp.

1850 census #229; William, 54, farmer, VT; Marie, 45, NY; Osker, 14, IL; Almond, male, IL; Carter, 7, IL.

VEAL: Andrew J. married Jane T. Hainline in this county on Feb 4, 1847. 1850 census #244; A.J., 24, laborer, KY; Jane 21, KY; John L., 2, IL.

WARREN: Francis W.; Hire Twp. died at Pittsburg Landing, May 15, of wounds received at Shiloh. Was a member of a McDonough Co. unit in the battle of Shiloh, Apr 6, 1862.

OMITTED: BUGHMAN: John; first wife, Celia, died at age 39y in May 1854. A dau, Flora E., born in 1852. John remarried; second wife, Susan, and 2 of their children who died in infancy, all buried in Huff Cemetery. John died in 1900 at age 79 years.

Notes, Corrections, Additions, and Changes

STICKLE CEMETERY

Location: Emmet Township; SW¼, Section 11; about 3 miles northwest of Macomb.

This cemetery is on Emerson Road, less than ¼ mile north of N1600 Rd. There is an entry to a grass path on the south side of the pond leading back to a wooded area containing the cemetery.

40° 30' 57.9" N: 90° 42' 37.4"W

Remarks: The following information was collected during mid-1973. Stickle Cemetery is located about 200 yards from an all-weather black-top road; the grounds are well-fenced on all sides and the area is in fair condition. The majority of the stones remain standing upright; several are severely weather-worn and nearly unreadable; a few markers have been broken. The grounds, at the time of this registration, were covered by a heavy growth of small trees and brush. NOTE: Capital letters in parenthesis, i.e. (NW), following the stone inscription indicates the section of the cemetery where that particular gravestone was located.

GATE:

Section NW	Section NC	Section NE
Section WC	Section C	Section EC
Section SW	Section SC	Section SE

ALLEN:

Thompson, son of Abram, Sr.; died Mar 16, 1872; age 25y 5d. (NE)
J.D.; d. Apr 14, 1872; age 17y 7m 20d. (NE)
Margaret; d. Mar 29, 1868; age 16y 6m 21d. (NE)
Lucinda; d. May 25, 1858; age 13y 2m 24d. (NE)
Abram, Jr., d. Apr 14, 1862; age 19y 13d. (NE)
Rhoda; d. Jun 26, 1866; age 17y 14d. (NE)
B.F.; d. Apr 12, 1888; age 30y 7m 7d. (NE)
Abram, Sr.; d. Dec 7, 1859; age 51y 8m 25d. (NE)
Mary Ann; d. Nov 21, 1857; age 45y 7m 26d. (NE) Inscribed on this stone, "Buried in Indiana"

BICE:

Lucinda (See INMAN)

BRANDON:

Eddie E., son of R.B. & M.M.; d. Mar 18, 1848; age 5m 1d. (C)

COULTER:

James; d. Feb 3, 1868; age 76y 1m 10d. (SC)

COX:

Loye, Jr.; b. Oct 11, 1934; d. Nov 18, 1934. (NE)

CROMER:

Florence; b. -----; d. Jan 4, 1958. (NE)
Samuel Fleet; b. Dec ---, 1875; d. Jul 17, 1945. (NE)
Davey H.; 1918 -1918. (EC)
Ernest Glen; 1912 – 19?35?. (EC)
Ira; d. -----; age 72y 10m (EC)
Cinderella; 1851 – 1927. (EC)
Benjamin; 1843 – 1925. (EC)

CRONE:

Henry S., son of ?E.A. & S.A.?; d. ----- 17, 1860; age 5y 6m 16d. (SW)
John B., son of E. & S.; d. Apr 19, 1861; age 1y 4m 21d. (SW)

DARLINGTON:

Lucy A., dau of W.C. & L.W.; d. Oct 25, 1859; age 8m. (NC)
Lucy W.; d. Aug 20, 1860; age 26y 3m 2d. (C)

DAURSON:

J.W.; d. Sep 11, 1859; age 12y 7m 8d. (WC)

DUNGAN:

Sarah, wife of E.; d. May 19, 1866; age 29y 1m 8d. (SW)

ELLESS:

Lana, wife of John; d. May 27, 1855; age 57y 11m 20d. (WC)

ELTING:

Robert F., son of P.H. & M.; d. Oct 26, 1859; age 3y 10d. (C)
Mary E., dau of P.H. & Margaret; d. Feb 14, 1852; age 4m 12d. (C)
Margaret A., dau of P.H. & M.; d. Oct 23, 1859; age 6y 11m. (C)
Magie D., dau of L.J. & A.B.; d. Mar 4, 1868; age 4m. (SC)

EYRE:

Elizabeth A., wife of George W.; d. Apr 1, 1852; age 35y 10m 20d. (C)

FRIZZELL:

Walter Scott, son of E. & E.; d. Mar 13, 1879; age 2m 13d. (NW)

HAINES:

Martha, wife of J.; d. Dec 8, 1867; age 84y 1m 21d. (C) [b. Oct 17, 1783]
James; d. Mar 21, 1853; age 71y 6d. (C) [b. Mar 15, 1782]
Martha J., wife of J.S.; d. Jan 13, 1858; age 26y. (C)

HALL:

Nancy (See INMAN)
Susan, wife of William; d. Oct 16, 1879?; age 58y. (SE)
Sarah Luella, dau of James & Mary; d. Aug 19, 1879; age 1y 9m. (SE)
Isaac, son of W. & S.; d. Jul 12, 1866; age 6y 6m. (SE)
Mary A., infant dau of W. & S.; d. Feb 7, 1867. (SE)
William; d. Oct 25, ?1871?; age ?48?. (SE)
Sarah J.; d. Jun 24, 1877; age ?22?. (SE)

HAYHURST:

Margaret; d. Apr 25, 1874; age 44y 5m 10d. (EC)
Hannah, wife of Benjamin; d. Sep 15, 1873; age 81y 24d. (EC)
Helner, dau of E.W. & A.; d. Aug 28, 1855; age 1y 3m. (C)

HENNEN:

Elizabeth, wife of E.H.; d. Aug 13, 1860; age 63y 5m 5d. (NW)
Columbus M., son of G.W. & N.M.; d. Feb 15, 1865; age 2y 28d. (NW)

HERRON:

Jason E., son of W.G. & M.E.; d. Apr 18, 1869; age 1m 9d. (SE)
Juliann L., dau of M. & A.G.; d. Jun 10, 1860; age 6y 6m 1d. (SW)

HICKSON:

Amanda ?R?., dau of T. & F.; d. ----- 5, 1880; age 30d. (NW)

?HOHENSHELL?:

John J., son of ---- & M.E.; d. Oct 13, 1864; age 1y 3m 2d. (WC)

HUMPHREY:

Mollie E., wife of ?J?. A.; d. Sep 2, 1866; age 21y 6m. (SC)

INMAN:

Elijah; 1858 – 1916. (NE)
Polly; 1851 – no date. (NE)
Edmund; Dec 17, 1853 – no date. (NE)
Lucinda Bice; Oct 28, 1858 – Feb 1, 1905. (NE)
Walter, E., son of E. & L.C.; Oct 8, 1879 – Apr 24, 1901. (NE)
Edmond; Mar 14, 1817 – Feb 2, 1880. (WC)
Nancy Hall, wife of Edmond; Dec 18, 1814 – Nov 14, 1907. (WC)
Randolph, son of Edmond & Nancy; Jun 15, 1844 – Dec 9, 1873. (WC)
Martha J., dau of E. & N.; d. Nov 23, 1865; age 19y 2m 17d. (WC)
William H., son of E. & N.; d. Jan 21, 1868; age 1y 2d. (WC)
Tenetie, dau of E. & N.; d. Mar 2, 1872; age 8m 27d. (WC)

IRWIN:

Ada C., dau of J. & E.; d. Aug 7, 1871; age 1y 6m. (SC)

KENNER:

David W., son of Wm. & E.E.; b. Dec 31, 1860; d. Mar 31, 1862. (WC)

KLINE:

Hezekiah; d. Oct 19, 1869; age 36y 10m 26d. (EC)

KOONTZ:

Josie L., wife of W.D.; b. Nov 29, 1854; d. Jul 15, 1902. (NE)
Carrie M., dau of W.D. & J.L.; d. Oct 8, ----- (NE)

LEACH:

Rufus; d. Aug 15, 1851; age 38y. (NC)

LEE:

Manerva J., dau of W.K. & J.B.; d. Dec 6, 1864; age 8y 10m 21d. (NW)

LONG:

John; d. Sep 11, ?1857?; age ?36y? 10m 24d. (WC)

LOWE:

Jane A.; d. Jun 23, 1882; age 55y. (NE)

Isabella; d. Nov 10, 1885; age 74y 9m 3d. (NE)

John; d. Oct 16, 1877; age 74y. (NE)

MC LEOD:

J.B., Dr.; d. May 7, 1865; age 65y 10m 4d. (NE)

William C.; 1825 – 1906. (NC)

Martha E., wife of W.C.; b. in Warren Co. VA; d. Sep 28, 1883; age 55y. (NC)

Garnett M., son of W.C. & M.E.; d. Jun 17, 1873; age 5m. (NC)

Mary E., wife of W.C.; b. in Frederick Co. VA, Sep 1, 1826; d. May 19, 1865; age 38y. (NC)

Annie T., dau of W.C. & M.E.; d. May 1, 1860; age 1y 13d. (NC)

Willie T.; d. Mar 21, 1858; age 5m 17d. (NC)

William C.; d. Oct 5, 1857; age 1d. (NC)

Robert S.; 1869 – 1930. (NC)

John M., son of W.C. & M.E.; b. Sep 5, 1861; d. Dec 31, 1890. (NC)

MILLER:

Amanda J. (See STICKLE)

Martha W.; b. Nov 30, 1801; d. Feb 12, 1879; age 77y 2m 12d. (C)

Robert F.; b. Mar 14, 1803; d. Oct 8, 1840; age 37y 6m 27d. (C)

Hiram A.; b. Jul 21, 1832; d. Oct 4, 1867; age 35y 2m 13d. (C)

MONGER:

Dovie, dau of J.H. & L.A.; d. -----; age 1y 1m 5d. (NE)

Birdie, dau of J.H. & L.A.; d. Jul 31, 1873; age 1y 1m. (NE)

James Harvey, son of A. & E.; d. Jul 9, 1861; age 1y 7m 1d. (NW)

Adam J., son of J.H. & L.A.; d. Jan 22, 1862; age 2m. (WC)

Melville, son of J.H. & L.A.; d. Sep 14, 1869; age 8m 8d. (WC)

James C., son of J.H. & L.A.; d. Feb ---, 1861; age 4m 6d. (WC)

Emeline, wife of A.; d. Jun 1, 1863; age 24y 6m 21d. (NW)

MOORE:

Infant dau of A. & L.C.; d. Feb 20, 1863. (NW)

MURPHY:

Arthur C., son of --- & ---; d. Mar ----, 186---; age 1y. (SW)

Mary S., dau of --- & ----; d. Mar 13, 1861; age -----. (WC)

John; d. Jan 1, 1859; age 31y 3m. (WC)

?Semantha J.?; d. Dec 23, 1859; age 59y 9m 23d. (WC)

Charles F., son of J.E. & M.E.; d. Sep 7, 1872; age 1y 1m 14d. (NW)

Infant son of B. & L.; d. Jul 9, 1871. (NW)

Charles, son of B. & L.D.; d. Aug 3, 1868; age 2m. (NW)

Mellcena, dau of B. & L.D.; d. Oct 4, 1866; age 1y 10m 19d. (NW)

Benjamin; d. Dec 7, 1867; age 78y 8m 22d. (WC)

Mary; d. Sep 6, 1869; age 82y. (WC)

PAINTER:

T.G.; d. May 29, 1870; age 72y. (EC)
Ann Matildea, wife of H.A.; b. Oct 21, 1830; d. Jan 15, 1906. (NE)
H.A.; d. Apr 17, 1865; age 36y. (NE)

PHILLIPS:

Louisiana, dau of J. & M.; d. Jun 2, 1861; age 7y 10m. (SW)

POST:

Sarah A., wife of Nicholas; d. May 28, 1905; age 85y. (SC)
Abraham W., son of J.N. & S.; d. Jun 10, 1857; age 2y 5m 28d. (C)
J.N.; d. Dec 29, 1868; age 49y. (C)

REESOR:

H.; (no dates). (NC)

RITCHIE:

Manda J., dau of H. & M.J.; d. Nov 11, 1863; age 1m 11d. (C)

ROLLINS:

Nellie, dau of J. & H.V.; d. May 11, 1875; age 22y 1m 23d. (NC)
James A., last son of J. & H.V.; d. Sep 15, 1874; age 29y. (NC)
William S., son of J. & H.V.; d. Aug 4, 1873; age 23y. (NC)
Infant; d. Apr 16, 1853; age 27y. (NC)
John H., son of J. & H.V.; b. Aug 23, 1843. "Enlisted in the Army of his country in July, 1862; -----; died in Hospital No. 14, Nashville, Tennessee. Co C, 84th IL Inf." (NC)

SADDLER:

William P.; 1856 - 1928. (NE)

SARLES (SEARLS):

James; 1790 – 1860. War of 1812. (C)

SCOTT:

Susan M., dau of W.K. & S.J.; d. Aug 1, 1855; age 1y 6m 25d. (C)
James; d. Dec 21, 1866; age 67y 6m. (WC)
Peggy, wife of J.; d. Oct 16, 1860; age 61y. (WC)

SEAMANS:

George B.; d. Dec 20, 1888; age 71y 10m 23d. (SE)
Phebe Ann; d. Dec 27, 1876; age 37y 8m 12d. (SE)
Sarah E.; d. Feb 28, 1875; age 16y. (SE)

SMITH:

Joseph; d. Apr 4, 1873; age 49y 9m. (SE)
James T., son of J.H. & Mary; d. Jan 10, 1875; age 21y 1m 13d. (SE)
Frankie, son of S.E.; d. May 10, 1877; age 6y 8m 3d. (SE)
Susan A., wife of C.M.; d. Feb 22, 1908; age 51y 7d. (NW)
Edman E., son of C.M. & S.A.; d. Feb 20, 1879; age 1y 6m. (NW)
Sarah A.; d. Sep 20, 1881; age 8m. (NW)
William N.; d. Apr 12, 1895; age 19y 14d. (NW)

STATLER:

Mary, dau of J. & H.; d. Mar 25, 1863; age 2y 1m 15d. (NW)
Infant dau of J. & H.; d. Feb 29, 1862; age 7d. (NW)

STICKLE:

Amanda J. Miller, wife of William; 1839 – 1888. (NE)
Carrie C., wife of C.W.; b. Apr 29, 1875; d. Jan 30, 1896. (NE)
Frank L., son of William & A.J.; d. Nov 13, 1877; age 4y 4m 22d. (NE)
William, son of William & A.J.; ----- (NE)

STICKLE (Cont'd):

William H., son of G. & J.; d. Sep 2, 1852; age 1y 11m 8d. (NC)

Ernie R., dau of G. & J.; d. Apr 28, 1886; age 20y 7m 14d. (NC)

George; b. Dec 12, 1819; d. Apr 28, 1899. (NC)

Julia A., wife of George; 1828 – 1910. (NC)

Susanna, wife of A.; d. Oct 8, 1839; age 50y 4m 14d. "Sacred to the Memory of Susanna Stickle, departed this life Oct 8th A.D., 1839, at 2 o'clock PM, age 50y 4m 14d." (C) [b. May, 24, 1789]

Robert N., son of A. & S.; d. Feb 11, 1853; age 21y 11m 27d. (C)

Abram; d. Sep 30, 1872; age 85y 7 29d. (C) [b. Feb 1, 1787]

Rachel, dau of A. & S.; d. Sep 30, 1839; age 17y 10m 2d. "Sacred to the Memory of Rachel Stickle, departed this life Sep 30th A.D., 1839, at half past 2 o'clock PM, age 17y 10m 2d." (C)

Sarah J., wife of A.B.; d. Feb 7, 1857; age 21y 8m 21d. (SC)

Frank A., son of A.B. & S.M.; d. Aug 31, 1872; age 6m 19d. (SC)

Mary D., b. Sep 16, 1878; d. Sep 20, 1878. (SC)

STUBBS:

Sarah C., dau of J.M. & S.J.; d. Mar 1, 1868; age 3y 9m. (NW)

Rachel, wife of J.M.; d. Sep 19, 1851; age 30y. (NW)

James M.; d. Jun 17, 1867; age 47y 3m 17d. (NW)

WATKINS:

Emma I., dau of J.G. & --.W.; d. Nov 20, 1866; age 1y 7m 2d. (WC)

Hannah A., dau of J.G. & F.; d. Mar 26, 1857; age 40y 4m 11d. (WC)

Susannah M., wife of J.; d. Mar 26, 1857; age 40y 4m 11d. (WC)

WORLEY:

Mary Ann, wife of David; d. Apr 18, 1866; age 27y 3m. (SW)

Johnnie, son of Mary & David; d. Apr 18, 1866; age 2y. (SW)

Genealogical Notes – Stickle Cemetery

ALLEN: Note the relative early age at which all members of this family died. No death records were maintained in this county prior to 1877; death certificate of Benjamin F. Allen states that he died on Apr 12, 1888 at age 30y 9m 7d. He was born in IN but had lived in IL the majority of his life. He was single, a farmer, and the cause of death was TB.

COX: Loye, Jr., was a son of Loye and ----- Cox. Mr. Cox died in a fire at his residence in Macomb; Mrs. Cox and 3 sisters of Loye, Jr., Charlotte, Loretta, and Elaine, survived.

CROMER: Benjamin was a son of Rebecca Hayhurst Cromer. She was a daughter of Benjamin and Hannah Hayhurst (See HAYHURST). Ben Cromer had 2 sisters --- Eliza, who married Aaron P. McKee on May 28, 1862 (Mr. KcKee's first wife, Hannah Hayhurst McKee, a sister of Rebecca Hayhurst Cromer, died early in 1862) and Anna, who married a Mr. Stewart. Ben's mother later married Isaac Strickland (1855 in IN). (Also see Vol. XVI, page 37).

Isaac Strickland died in Macomb on Jul 24, 1898 at age 69 and was buried in Oakwood Cem. Mr. Strickland was a native of Fulton Co. IL, but lived several years in IN. Mr. Strickland and Rebecca Hayhurst-Cromer Strickland had the following children: Elisha, who married in 1879 to Isabelle Head of Sciota and died near Youngstown, IL in 1913 at age 57; William, who lived in Warren Co. IL; James of Macomb; and Mrs. Charles (Margaret) McGrew, who moved to Seward, NE.

CROMER (Cont'd): The Cromer family from Emmet Twp. lived in a house on the F.M. Painter farm. The house was moved in early 1911 to the rear of the Painter residence and was to be used for a chicken house.

ELTING: Robert F., Mary E. and Margaret A. were children of Philip and Margaret (McSpiritt) Elting. Philip Henry Elting was born in Dutchess Co. NY Feb 14, 1815; his father a native of Holland & mother of France; father a rich merchant & owned line of steamers from NY to Albany on Hudson River; family moved to Quincy while visiting there; Philip worked for his father in NY as a bookkeeper; moved to this county in 1834 & took charge of property which his father had bought earlier; he owned land where present Bushnell located; bought by buying up tax titles in NY; he died Jul 22, 1876 and buried in Oakwood; he lived in Emmet, Sec 12, at the time of his death; owned 560A when died; Philip Henry Etling married Jan 23, 1834 to Margaret McSpiritt, dau of Francis McSpiritt who located on sec 24 Emmet Twp. in 1837; Elting then lived on sec 13, Emmet and later, John Elting lived there and moved to sec 12 in 1860; widow lived there in 1885; Philip & Margaret had 12 children: Chas. M.; Levi Jones; Harriett A.; James; John; Francis C.; Nellie M.; Philip E.; and Mary L. Robert, Mary and Margaret died young.

Margaret Elting was a daughter of Francis & Mary (Campbell) McSpiritt; born in Enniskillen, County Ermanagh, Ireland. Mr. & Mrs McSpiritt also moved to McDonough Co. and settled in Emmet Twp. about 1837.

1850 census #189; Philip H., 34, farmer, NY; Margaret, 28, Ireland; Charles, 11, IL; Levi J., 8, IL; Harriett, 6, IL; James, 4, IL; and John, 1, IL.

Magie D, was a daughter of Levi Jones Elting and a granddaughter of Philip H. & Margaret (McSpiritt) Elting.

John Elting married Lucy McLeod, dau of Wm. & Mary W. McLeod on Feb 3, 1876; Lucy born in MO.

EYRE: Elizabeth A., wife of George. George W. Eyre was born Sep 20, 1812 in PA. He moved to this county in 1837 and farmed in Emmet Twp. Geo. W. and Mrs. Elizabeth Gordon were married in this county on Mar 9, 1838.

FRIZZELL: Walter Scott, son of E. & E. Frizzell; d. Mar 13, 1879; age 2m 13d. County records reveal that he was born in Emmet Twp. and died on the dated noted above; cause of death was cholera.

HAINES: Martha J., maiden name was Humberd; married James S. Haines in this county on Feb 1, 1849. 1850 census #219; James S., 29, carpenter, TN; Martha, 18, IL; Samuel R., 4 mos, IL; Landa HUMBARD, 23, male, farmer, TN; Rebecca HAINES, 32, IN; Martha ABBERTON, 25, IN; James H. ABBERTON, 8, IL.

HALL: William Hall owned and operated an 80A farm in section 15, Emmet Twp. According to county court records, Susan Hall died on Dec 16, 1880 at age 58 years. She was a native of England and had lived in IL since 1865. The cause of her death was TB. Sarah L. Hall died on Aug 18, 1879; age 1y 8m 22d; cause of death listed as cholera; born & died in Sciota.

HAYHURST: Benjamin Hayhurst farmed in Emmet Twp. and owned about 180A in sections 11 & 15. One of his daughters, Hannah, married Aaron P. McKee and died at age 29 years on Feb 1, 1862. She was buried in Pearce Cemetery in Walnut Grove Twp.

INMAN: Edmond Inman died Feb 3, 1880; age 62y 11m 26d; cause of death was pneumonia. Mr. Inman was born in KY and had lived in this county for 46 years. He was a farmer; died in Emmet Twp. Edmond married Nancy Hall in this county on Dec 30, 1841. 1850 census #225; Edward, 37, blacksmith, KY; Nancy, 33, KY; Randolph, 6, IL; Martha, 4, IL; Polly, 10 mos., IL. Edmund was also a son of Edmond and Nancy Hall Inman.

INMAN (Cont'd): Lucinda (Bice) Inman was a daughter of James and Frances Aukron Bice; her father was a native of Carlisle, PA and was raised in Washington Co. PA; her paternal grandfather, Nicholas, and her great-grandfather, Joseph Bice, were also natives of Carlisle. Nicholas Bice settled in this county in 1853 and located on sec 14, Hire Twp. He bought 120A there and lived at this location about 20 years; then moved to town of Blandinsville; died there. James Bice married in PA to Frances Aukron on Aug 31, 1843. Mrs. Bice was a daughter of Joseph & Elizabeth Aukron from Green Co. PA. After their marriage, James & Francis parents in this county and decided to relocate to this area. They bought a 80A farm in section 27, Hire Twp. and moved there in the mid-1850's. Other children in the family were Isaac, Rebecca, Nicholas, Jane, Sarah, Franklin, and David. Rebecca married Thomas Foley; Jane married Thomas Hainline; and Sarah married James Strickland. Lucinda was the 5th child of Mr. & Mrs. Bice.

KLINE: Hezekiah; native of Westmoreland Co. PA; married Mary Ann Painter, a daughter of Tobias George Painter; Mr. Kline moved to this county in 1866; was in lumber business; he died in 1869; Mrs. Kline later moved to Kansas where she died in Jan 1887. Kline's had only one child – Clarence P.; in 1898, Clarence married Beryl Painter, a daughter of Francis Marion Painter; both Clarence and Beryl were grandchildren of Tobias (or Tobis) G. Painter.

The widow of Hezekiah apparently married a man named Ellis; Clarence P. Kline, in 1907, had a half-brother named Elmore W. Ellis, who was living in Chicago at that time. Clarence P. moved to Kansas City, MO in 1884 & lived there several years; his mother, Mary Ann, lived with him & his family till her death.

KOONTZ: Josie L., wife of W.D. Koontz, was a daughter of Henry A. Painter. Mr. Painter was the 2nd child of Tobias & Catherine (Painter) Painter and was born in 1829 in PA. Moved to this county with his parents.

LEACH: Rufus; farmer and pioneer settler of this county; born in Essex Co. NJ; moved to Cleveland, OH area and later to IL; bought farm from U.S government near Good Hope; had a daughter, Harriet, born near Spring Creek in Nov 28, 1842. She married William Mitchell Lipe and lived in Macomb. Rufus married Lois Searles in this county on Apr 9, 1840. 1850 census #194; Rufus, 36, farmer, NY; Laura, 24, IN; Harriett, 6, IL; John, 3, IL; Albert I., 1, IL; James LUSK, 60, farmer, NY

LOWE: John (1803-1877) moved to the U.S. from Leitrum, Ireland at age 3 years with his parents, John & Nancy Todd Lowe; they lived for a time near Orion, IL where his parents died. Jane Lowe (1827-1882) was an only child of John Lowe and his first wife. John remarried to Isabelle Riley, born Feb 7, 1811. They had a son, William H. Lowe who served in the Civil War; this family lived in Fulton Co. at one time (a sketch of the life of Wm. Lowe is in a Fulton Co. History). NOTE: A great-great granddaughter of John & Isabella Lowe is Wanda (Mrs. James) Mowry living in Gering, NE in Sep 1971.

John Lowe was the owner of an 80A farm in section 10, Emmet Twp; also, a John W. Lowe was the owner of a 160A farm in section 15, in neighboring Sciota Twp. at this same time period.

MC LEOD: Dr. John B. McLeod, a physician from New Town, VA was the father of William C. McLeod. Dr. McLeod had practiced medicine in Virginia for over 30 years. His son moved west in 1850 and settled in this area in 1858. Dr. McLeod and his wife visited their son and his family in Emmet Twp. in early 1865 and while on that visit, Dr. McLeod became ill and died. His widow subsequently returned to her home state of VA and she died there on May 27, 1874 at age 74 years.

MC LEOD (Cont'd): William C. McLeod was born near New Town, Frederick Co. VA Mar 25, 1825; son of John B. & Ann S. (Carson) McLeod, both natives of the same county. William C. began working as a carpenter at age 18, and in 1850, he moved to Palmyra, MO and was in the lumber and building business there for a number of years. In 1858, the Governor of MO appointed Mr. McLeod to enlarge the State Prison at Jefferson City. In Oct of 1858 Mr. McLeod and his wife, the former Mary Miller, relocated to this area and settled on section 14, Emmet Twp. Mary Miller McLeod was a daughter of Robert F. and Martha W. Miller. William and Mary had 8 children – Annie T. died in May 1860; Willie T., and William C., twin sons died in Oct 1857, died at early ages; Lucy, who was born in MO later married John Elting; John M., another son, died in Dec 1890 at age 29y. The first Mrs. McLeod, Mary, died in 1865, and on Oct 5, 1868; William married Martha E. Simpson. Two children by this marriage, Garnett M., who died in 1873; and Robert S., who died in 1930 at age 61y. The second Mrs. McLeod died in 1883. In 1885, Mr. McLeod returned to VA and lived there a short time; returned to this county and died in 1906. William was the Superintendent of Construction for the McDonough County Jail which was built in 1876-77. He ran for sheriff of the Democratic ticket in 1868; defeated by slim margin. While in MO he served as the Palmyra city constable and marshal. He was later the McDonough County chairman of the board of supervisors, the Emmet Twp. clerk, collector, and treasurer. An early account of the life of Mr. McLeod states that at age 52 years he was about 5'11", weighed 175 pounds and was in generally good health.

Martha E. (Death notice, in part, from The Macomb Journal, Oct 4, 1883): "Mrs. Martha McLeod, wife of W.C. McLeod, died at her residence in Emmet Twp. on Sep 28th, aged 57 years. She was born in Warren Co. VA where she resided until she married Wm. C. McLeod about 15 years ago. Afterwards she came with him to his IL home. She was buried in the Stickle graveyard...."

A daughter of William's, Mattie I. McLeod, died on October 11th, 1887, at the home of her sister, Mrs. Minnie McGinnis, near Powhatten, Brown Co., KA. Mattie was born in this county on Sep 1, 1863, and had lived with her parents till her mother died in 1883, when she went to live with her sister in KA. She was buried at Grand Prairie Cem. near where she died. (Information from The Macomb Journal, Oct 27, 1887).

MILLER: The Miller family lived on section 14, Emmet Twp. Martha W. Miller was listed as owner of 320A in this section in 1870. 1850 census #220; Martha W., 49, VA; Mary A., 23, VA; Ann, 19, OH; Atwell, 17, male, OH; Lucy, 15, OH; Eveline, 13, IL; Amanda J., 10, IL.

MONGER: Dovie & Birdie, daus of J.H. & L.A., were two granddaughters of Adam & Emeline Monger.

Adam & Emeline (Hudson) Monger were married in 1853 and had 3 children; all 3 died at an early age. Mrs. Monger died in 1863; Adam then married Ruth A. Hudson in 1866. Three children born to them: Cora Dell, who married Charles McNalley; Ira, and Lucinda N. Adam was born in Ohio on Jan 17, 1832 and was raised on a farm in Clinton Co. OH. He and his first wife, Emeline, moved to McDonough Co. in 1854 and first lived on a 160A farm in Sciota Twp. The family lived here until about 1870, when they moved to the town of Good Hope and Mr. Monger entered the livery business. In Dec 1884, Monger traded this business for a livery stable in Macomb, then owned by Benjamin Murphy.

(1907 History): Adam Monger, native of OH & moved here in 1854; had a wife whose maiden name was Sidney Johnson; they had a dau, Eliza E., born in Clinton Co. OH. In 1868, Eliza married in Emmet Twp. to W.H. Smith; Smith born in OH in 1846, son of Jacob & Mary Wolfe Smith; Smith farmed near Good Hope & moved there about 1887; moved to this area in 1865; bought a farm in Sciota Twp. moved in 1870 to Iowa & bought a farm there; lived in Iowa 2 years; came back here & bought an Emmet Twp. farm on the Emmet-Sciota Twp. line; sold it in 1887 & moved to a 162A farm near Good Hope. Vet of 85th OH (1862). W.H. & Eliza (Monger) Smith had 6 children: Arthur & Edgar, Emmet Twp.; Charles W., Sciota Twp.; Harvey & Alvah, Rock Island, IL; Pearl, living at home in 1906.

MURPHY: Benjamin Murphy, Sr., was born in Delaware. He married Mary Brown, a native of VA, and moved to McDonough Co. about 1859 or 1860, 6 years after his son, Benj. , Jr. moved here; Benj. Sr., bought the "Hickman" farm in Sciota Twp. and lived there rest of life.

Infant (d. 1871), Charles and Mellcena were 3 children of Benj. Jr. and Louisa D. (Monger) Murphy. Benj. Jr., son of Benj. Sr. and Mary (Brown) Murphy. Benj. Jr. was born in Clinton Co. OH on Nov 15, 1828; moved to McDonough Co. about 1855; settled in Sciota Twp.; married Louisa Monger on Mar 18, 1858 and in addition to the above named children, had the following: James; John W.; Cynthia A.; Ellsworth; and Thomas. Mr. & Mrs. Murphy are both buried in Good Hope Cemetery. Mrs. Murphy died in 1880.

PAINTER: Tobias George Painter; born in Dec 1798, Westmoreland Co. PA; was of German descent; married Catherine Painter, a daughter of George Painter, in PA; Catherine also born in PA about 1804. Tobias G. & Catherine moved west about 1830 and first settled at Beardstown, IL; moved to this county a few months later; lived with the William Pennington family for one winter. They lived a short while in section 8, Industry Twp.; then moved to Spring Creek area in Emmet Twp. The Painters had 7 children: Isabel; Henry A.; John F.; Francis Marion; George B.; Jacob L.; and Mary Ann. Isabel married Thomas Head of Sciota. Mary Ann married Hezekiah Kline; Francis Marion married Josephine Kitch. At the time of his death Mr. Painter was the owner of about 1300A of land in this area. On the death of T.G. Painter, Francis M. took control of the family farming interests. He married Josephine Kitch on Jun 25, 1880. One of their daughters, Berly, later married Clarence P. Kline, the only child of Hezekiah & Mary Ann (Painter) Kline. Catherine, the widow of Tobias George Painter, died in 1893.

Isabel Painter Head, T.G. & Catherine's oldest daughter, died in 1921 and was buried at Spring Creek Cemetery in Emmet Twp.

Francis Marion, 4th child of T.G. & Catherine (Painter) Painter, was born in Emmet Twp. Nov 15, 1835 (?); died at age 84; buried in Oakwood Cemetery on Sep 17, 1921.

Jacob L., son of T.G. & Catherine (Painter) Painter, died May 15, 1877 at age 35y; buried in Spring Creek Cemetery.

Henry A. Painter (See KOOTZ).

1850 census #212; Tobias G., 51, farmer, PA; Catherine, 48, PA; H.A., 20, male, PA; Tobias G., 18, IL; Francis M., male, 15, IL; George B., 12, IL; Jacob L., 29, IL (handwritten is name John]

PHILLIPS: Louisiana was a daughter of John C. & Mary A. (Collins) Phillips. John C. Phillips was a blacksmith in Blandinsville in the late 1800's. He was born in Tuscarawas Co. OH on Jan 4, 1831 and lived there till about 1855. He married Mary A. (Collins) on Jul 13, 1851; she was a native of Morgan Co. OH; born Feb 26, 1834. He and his wife moved to Henderson Co. IL in the fall of 1856 and lived about 8 miles north of Blandinsville. In Mar 1857 they moved to Emmet Twp. and lived there several years. On Aug 14, 1862, Mr. Phillips entered military service and served about 3 years with the 124th IL Inf. Mr. & Mrs. Phillips had 10 children: Louisiana died 1861; Cerenia C., born in 1855; William A., born in 1856; Virginia A., born in 1858; John Franklin, born in 1861; Mary O., born in 1862; James B.M., born in 1866 & died in 1868; Eddie M., born in 1868; Lucy A., born in 1870; Charles O., born in 1872. William A., who was born in Henderson Co on Nov 2, 1856, married in 1883, to Ann Jackson of Quincy. He later became a wagon maker and operated his business in Blandinsville. John C. Phillips was buried in Glade City Cemetery in Blandinsville; lot #130, 2nd addition.

POST: J.N. Post owned a 160A farm in section 22, Emmet Twp.

REESOR: H.; only the name appears on this small stone. A REESOR family moved to IL in 1834 from Montgomery Co. OH and lived in Tazwell Co. for about 7 years and then moved to the south part of McDonough Co. Eldorado Twp.

RITCHIE: Martha; d. Dec 20, 1879; age 33y 1m 27d.; farmer's wife & weaver; b. in Highland Co. OH, Oct 23, 1846; resident of IL 25 years; d. at home in Emmet Twp.

ROLLINS: 1850 census #196; Joseph, 36, farmer, KY; Harriett, 35, KY; Nancy L., 9, IL; John H., 7, IL; Phillip, 1, IL; and James A., 4, IL. Joseph & Harriet Rollins along with Miss I. Ella Rollins were original members of the Good Hope Presbyterian Church which was organized in 1869; they had transferred from the Macomb Church at that time. Rollins family farmed just west of the present site of the junction of US Rt 67 and IL Rt 9. Their children attended Prairie Hill School which was located mid-way between Good Hope and Macomb. J. Rollins was indicated (in 1870) as owner of a 140A farm in section 2, Emmet Twp.; moved to this county in 1840 from his native state of KY.

SARLES: James; 1790-1860. Government headstone indicates Mr. Sarles was a veteran of the War of 1812. Wife was Ruth; they lived in Clark Co. IN, where several children were born. Among the children were Sarah Ann (Mrs. John C. Hall); Harriet (Mrs. Spangler); and Lois (Mrs. Leach).

SCOTT: Susan M. was a daughter of Walter (or Walton) K. and Sarah Jane (Stickle) Scott who were married in this county on Oct 26, 1848. 1850 census #273: Walter, 28, laborer, PA; Sarah J., 21, PA; Mary E., 1 mo. IL; H. JOHNSON, 15, NY.

SEAMANS: George B. Seamans and his family lived in Section 13, Emmet Twp. where he owned an 80A farm.

STATLER: Mary and Infant Statler were children of James & Hulda (Murphy) Statler who moved to this county in 1855 from Clinton Co. OH; later moved to Macomb; a son, Samuel, farmed in Emmet Twp. James Statler was born in Clinton Co. OH Aug 28, 1830; parents were Samuel & Mary (HARRIS) Statler, natives of VA; moved to OH at early date & James was raised there; farmed till 1853; moved to Knox Co. IL; there 2 years; then to Sciota Twp.; there a year; moved to section 1, Emmet Twp. and there till fall of 1865; moved to Macomb and in general store there 3 years; returned to farm; in 1877 entered grain trade in Good Hope; also in general store business in 1882; married Hulda J. Murphy in 1851; she a native of OH. In addition to the 2 children of the Statlers that are buried in this cemetery, James & Hulda had 5 children living in 1885; Samuel; Maria A.; Emma; and William T.

STICKLE: Abraham or Abram was born in York Co. PA Jan 21, 1787; son of Peter & Mary (Hollipeter) Stickle; Abraham raised in PA and married there to Susanna (Bentzley) who was born May 24, 1789; they married Oct 11, 1810 & moved to this county in 1839; Stickle owned land in Macon Co.; bought 160A on section 11, Emmet; later bought more; he died Sep 30, 1872; had 10 children: Mary; Matilda (died); Susan; Jacob; George; Rachel (died); Wm.; Abraham B.; Robert N. (died); Sarah J. Mary moved to PA; Susan to Michigan City, IN; Jacob to Brown Co. KA; George, Wm., & Abraham B. in Emmet Twp.; Sarah J. moved to Abingdon, IL.

Abraham B. Stickle, son of Abraham; lived on family homestead in Emmet; owned 160A homestead plus about 900A; cost of old homestead was \$7,000; Abraham B. lived there since childhood; married Aug 10, 1853 to Sarah Duncan, a native of KY; she was a daughter of Wm. & Catherine Duncan, early settlers of this county; Wm. Duncan died in 1859; widow lived with children; Stickle's had 2 children: Amanda A. and Wm. H.; Sarah died Feb 7, 1857; Amanda married George Currier and moved to KA; Wm. also moved to KA; Abraham then married on Jan 1, 1860 to Sarah Metcalf, daughter of Wm. & Deborah Metcalf of Carthage, IL; Wm. an early settler of Hancock Co. and veteran of Mormon War; Stickle's had 8 children; 6 living in 1885; Mianna married Oscar McElvain; Arthur R.; Delia; Walter; Edwin; Fred; Frank (died); Mary (died). Sarah (Metcalf) Stickle died in Sep 1914, and was buried in Oakwood Cemetery, Macomb.

STICKLE (Cont'd): George Stickle, 2nd son of Abraham and Susanna (Bentzley) Stickle lived with parents till 1849; married May 17, 1849 to Julia George native of Northampton Co. PA; she born Jan 1829; her parents, John and Mary (Barrett) George died in PA; George settled on section 10, Emmet after marriage; owned 200A; had 6 children on section 10, Emmet after marriage; owned 200A; had 6 children living in 1885; Sadie married Thomas Champion; Ella became an artist; Frances married Harvey Oatman; Emma, Alice, & Ernie B.; oldest child Wm. H. died at age 2y.

Ernie R. (Death notice, in part, from The Macomb Journal, May 6, 1886): "Ernie B., daughter of George & Julia Stickle was born Sep 14, 1865 and died Apr 28, 1886 at the family home in Emmet township, aged 20 years 7 months and 14 days. She was the youngest in the family. She was a sister of Mrs. Harvey Oatman of Prairie City..."

Wm., son of Abraham & Susanna (Bentzley) Stickle was born in PA Jan 31, 1824; to this county with parents in 1839; went to CA in 1850 and there 8 years; returned here in spring of 1858; married Mar 16, 1859 to Amanda J. Miller who was born Oct 25, 1839; Wm. then went back to CA and mined till Oct 1868; reportedly had fair success; returned to Emmet and bought 123A on sec 2; also had 80A on sec 11 and 26A timber on sec 16; had 3 children living in 1885; Chas. W. born Feb 7, 1860; Kitty May born Sep 25, 1863; Edgar Carson born Jan 31, 1875; Wm. E. born Oct 16, 1861, died in Sep 1882; Frank L. born May 21, 1873, died Oct 13, 1877; oldest son, Charles W., a telegrapher in NE in 1885. Amanda J. (Miller) Stickle died on Jul 9, 1888 at age 48 years; cause of her death was cancer.

Sarah (Metcalf) Stickle died in Sep 1914; funeral conducted at Stickle Church (last known funeral service conducted there); she was buried at Oakwood Cem. in Macomb. A granddaughter of Mrs. Stickle, Ruth S. Stickle, who currently lived at Elmhurst, IL stated that she attended this funeral and road to the Oakwood gravesite in a surrey with her uncle, Arthur R. Stickle. The other family members drove from Stickle Church to the cemetery in a Hupmobile. (NOTE: Ruth S. is a daughter of Fred Stickle; she also has a sister, Nellie, living in Elmhurst, IL and a brother, Owen, in TX).

Fred Stickle's wife's maiden name was Searle; her sister, Nellie Searle lived in Rock Island in 1903.

STUBBS: J. M. Stubbs owned and operated a 100A farm located in sections 7 & 8, Emmet Twp. 1850 census #192; James W., 31, farmer, TN; Rachel, 28, TN; and William, 3, TN.

WORLEY: Mary Ann, wife of David, and their son Johnnie, both died on the same date.

NOTE: County court records indicated that the following were buried in Stickle Cemetery, however, no stones or markers were located for these persons.

WHITE: Abraham Paul; d. Sep 9, 1878 at age 11m 9d; cause of death was TB.

Julia Ann, d. May 17, 1878; age 29y 9m 16d.; cause of death was TB; b. in OH; resident of IL 25 years; married; buried at Stickle Cem.

NOTE: STATLER, infant dau of J. & H. Statler; died Feb 29, 1862; the date of death as it appears on this stone – Feb 29, 1862 is an incorrect date as 1862 was not a leap year.

Notes, Corrections, Additions, and Changes

WALKER CEMETERY

Location: Emmet Township; SW¼, Section 8. 5 miles west of U.S. Highway 67 on Spring Lake Road, north 2 miles on McDonough County Road 6. [This cemetery is located just west of the junction of N1650 Rd and E725 St. 40° 31' 24.6" N: 90° 46' 13.8"W](#)

Remarks: Appears to be regularly maintained; the estimated 2-acre cemetery is fenced on all sides. Most stones are standing upright; however, many are badly weather-worn.

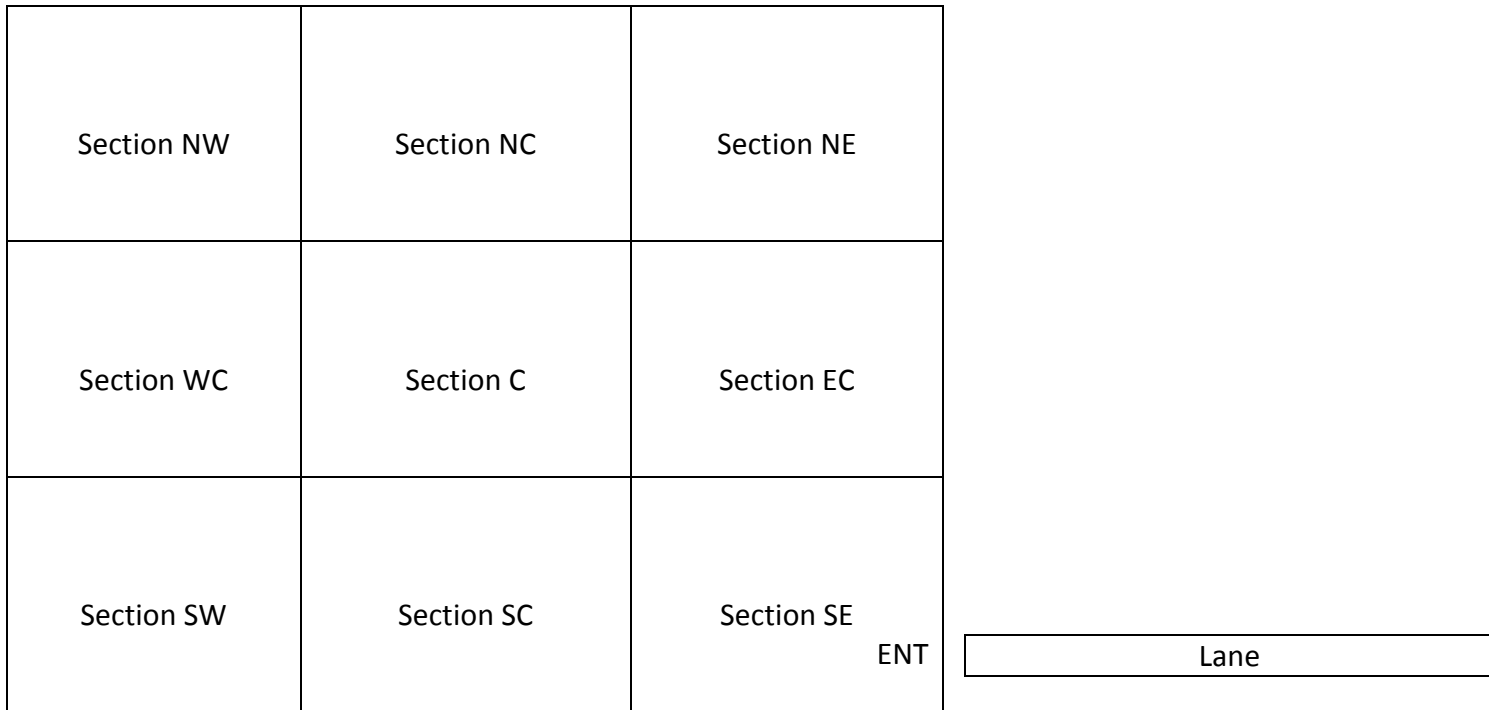

BINGHAM:

- Willard; d. Jun 10, 1893; age 3y 7m 17d. (EC)
- Earle; d. Jun 5, 1893; age 7y 2m 23d. (EC)
- Lizzie; d. Jun 2, 1893; age 9y 4m 3d. (EC)
- (Above were children of Robert & Eliza Bingham).

BUGG:

- Allice, dau of J.W. & F.A.; d. Feb 1, 1861; age ----- (C)
- Jesse W., Jr.; d. May 11, 1889; age 62y 5m 16d. (C)
- Frances A., wife of Jesse W., Jr.; d. Oct 7, 1865; age 30y 2m 16d. (C)
- Benjamin F., son of J.W., Sr. and M.A.; d. Feb 17, 1863; age 25y 1m 13d. "Co 'I' 124th IL Inf. (C)
- Martha A., wife of Jesse W. Sr.; d. Aug 17, 1877; age 74y 2m 18d. (C)
- Jesse W., Sr.; d. Apr 13, 1873; age ?87?y 4m 2d. (C)
- Oliver E., son of William G. & Jane; d. Sep 17, 1885; age 16y 5m 29d. (SC)
- Willie C., son of W.G. & J.; d. May 5, 1885; age 7y 9m 9d. (SC)
- Margaret; 1852 – 1930. (EC)
- James W.; 1844 – 1913. (EC)

BUSHNELL:

Mary E., wife of Homer; d. Sep 19, 1871; age 22y 11m 4d. (C)
Charles H., son of H. & M.; d. Dec 3, 1881; age 13y 2m 29d. (C)

CAMPBELL:

Arthur U., son of T.F. & R.; d. Aug 7, 1864; age 1y 6m. (C)
Senie W. (See GRIFFITH)

CANNAN:

Mary; d. Apr 5, 1874; age 44y 12d. (EC)

COLVIN:

Christ Anna, wife of H.C.; d. Mar 16, 1873; age 47y. (NW)

CORD:

Benjamin F., son of H.C. & Z.; d. Apr 11, 1862; age 1y 1mm. (WC)
Sarah J., dau of H.C. & Z.; d. Feb 27, 1861; age 16y 10m 9d. (WC)
Missouria A., dau of ?H.C. & Z.?; d. May 17, 1863; age 16y 8m 5d. (WC)

FOLEY:

Winnie E., son of W.H. & E.L.; d. Jun 21, 1874; age 4m 7d. (C)
Alva E., son of W.H. & E.L.; d. Mar 26, 1867; age 1y 5m 20d. (C)
Etta A., dau of W.H. & E.L.; d. Feb 11, 1867; age 3m 23d. (C)
W.H.; d. Jun 8, 1874; age 31y 11m 22d. "Co 'C' 84th IL Inf."
Eliza A., wife of John K.; d. Jul 29, 1874; age ----. (SC)
Alice A., dau of J.K. & E.A.; d. Oct 13, 1877; age 18y 27d. (SC)

GILLIAN:

Rosamond; b. Jun 15, 1791; d. Jan 7, 1881.

GREENLEAF:

Lucy M.; Feb 4, 1890 – Apr 22, 1890. (WC)
Lorenzo M.; Oct 30, 1887 – Jan 23, 1888. (WC)

GRIFFITH:

Percy C.; 1872 – 1938. (WC)
Edwin J.; 1871 – 1935. (WC)
Amanda C.; 1847 – 1921. (WC)
John A.; b. Oct 20, 1847; d. Apr 5, 1881. (WC)
?William?; stone unreadable; Government headstone indicates service during the Civil War.
Bertrand, son of W.C. & E.A.; d. Jan 8, 1872; age 10d. (WC)
Allie M. & Carrie A.; d. Mar 11, 1875; age 2m 21d. (WC)
Luna D.; d. Nov 18, ?1873?. (WC)
Infant children of ?C.F. & A.? Griffith; d. Apr 15, 1871. (WC)
Henry C.; Dec 14, 1837 – Oct 18, 1911. (SW)
Senie W. Campbell, wife of Henry; b. in Monroe Co. IN, Jul 16, 1844; d. May 5, 1897. (SW)
Nancy A.; b. Dec 6, 1812; d. Sep 21, 1898. (SW)
James D.; b. in Buckingham Co. VA, Jul 20, 1810; d. Jan 5, 1897. (SW)

GUY:

M. Winnifred; 1881 – 1969. (WC)
W. Franklin; 1877 – 1959. (WC)
Mary Ellen; 1907 – 1921. (WC)

HANKINS:

Mary Lou, dau of F.L. & A.M.; d. Jun 18, 1884; age 5y 8m 2d. (NC)

HILL:

John W., son of Jacob M. & Elizabeth; d. May 10, 1855; age 19d. (C)

JOHNSON:

Catherine, wife of William F.; Oct 12, 1818 – Jul 18, 1895; age 76y 9m 6d. (NE)
William F.; d. Sep 24, 1883; age 70y 5m 16d. (NE)
Cora J., dau of G.M. & M.E.; d. Dec 6, 1877; age 3y 7m 26d. (NE)
Georgie L., son of G.M. & M.E.; d. Nov 30, 1877; age 5y 1m 27d. (NE)
Martha E., wife of G.M.; d. Aug 16, 1881; age 30y 5m 5d. (NE)

MC GRAW:

James M., son of J. & J.M.; d. Dec 26, 1860; age 19y. (C)
Thomas F.; d. Aug 6, 1865; age 21y. "Co 'B' 16th IL Inf. (C)
Jane W., wife of Jackson; d. Feb 16, 1851; age 41y 6m 5d. (C)
Jackson; d. Oct 8, 1858; age 44y. (C)

NULL:

Sarah A.; 1841 – 1922. (SW)
Israel; b. Oct 1, 1810; d. Jul 17, 1901. (SW)
Elizabeth, wife of Israel; b. Oct 5, 1810; d. Feb 12, 1885. (SW)
Addie E. Shryack, wife of H.I. Null; d. Jan 11, 1883; age 30y. (SC)
Asa I., son of H.I. & A.E.; d. Dec 27, 1883; age 11y 11m. (SC)
Mary E., dau of H.I. & Clara; d. Mar 26, 1886; age ----. (SC)

PENNINGTON:

Riley; d. Nov 12, 1873; age 63y 10m 29d. (WC)
Alice M., dau of H. & C.; d. Sep 15, 1871; age 17m 15d. (WC)
Ali A.; b. Jul 25, 1838; d. Apr 27, 1897. (NC)
Eliza Emeline, wife of Eli A.; b. Feb 13, 1845; (no date). (NC)
Mamie R.; d. Dec 23, 1889; age 17y 4d. (NC)
William J., son of E.A. & E.; b. Oct 17, 1874; d. Mar 3, 1880; age 5y 4m 16d. (NC)
Louis J., son of E.A. & E.; d. Jul 19, 1871; age 2m 25d. (NC)
Rebecca, wife of William; d. Oct 17, 1871; age 72y 10m 10d. (NC)
John I., son of William & Rebecca; d. Jan 6, 1870; age 25y 9m 18d. (NC)
William; b. Mar 25, 1799; d. Feb 19, 1880. (NC)
Alfred; d. Mar 2, 1895; age 67y 1m 21d. (NC)
Martha P., wife of J.R.; d. Dec 5, 1862; age 20y 5m 8d. (NC)

POFF:

R. (Nothing more on this small stone). (WC)

PURDY:

Rachel, wife of R.C.; d. Feb 26, 1853; age 26y 15d. (WC)

PURMAN:

Samuel E.; d. May 29, 1890; age 7y 6m 14d. (NC)
Bessie B.; d. May 22, 1890; age 6y 2m 3d. (NC)
Bertha M.; d. Jun 6, 1890; age 4y 4m 26d. (NC)
William S.; d. May 30, 1890; age 10m 14d. (NC)
Eli; d. Nov 4, 1887. (NC)

(All of above were children of A.M. & M.E. Purman).

SELLERS:

Amor J., child of M.A. & E.A.; d. Jan 31, 1891; age 11m 11d. (NE)
Infant son of M.A. & E.A.; d. Feb 3, 1881; age 2d. (NE)
Infant son of M.A. & E.A.; d. Apr 25, 1888; age 3 hours. (NE)
Infant dau of M.A. & E.A.; b. & d. Mar 17, 1896. (NE)
Melissa, wife of Thomas; b. Jan 6, 1814; d. Sep 3, 1901. (NE)

SHRYACK:

Addie E. (See NULL)

William; d. Feb 8, 1860; age 72y 6m. (Government marker: Pvt, Wood's Co "I", MD Mil, War of 1812). (WC)

Eliza J., wife of Wm.; d. May 31, 1863; age 61y 4m 26d. (WC)

John Lawrence, son of W.L. & Ann; d. Oct 10, 1873; age 11y 5m 1d. (WC)

Ann, wife of W.L.; d. Oct 8, 18---; age 53y 7m 27d. (WC)

Cordelia, wife of W.L.; d. Apr 30, 1890; age 56y. (WC)

Alta E., dau of L. & C.; d. Aug 28, 1871; age 10m 3d. (SC)

Infant dau of L. & C.; d. Sep 19, 1865; age 19d. (SC)

Lucius; b. Dec 22, 1829; (no other dates). (SC)

Caroline E. Wear, wife of Lucius; b. Jul 12, 1837; d. Dec 10, 1905. (SC)

Golda Odella, dau of George & Clara A.; b. Nov 3, 1899; d. Sep 6, 1900. (SC)

SIDERS:

Henry; d. Sep 2, 1860; age 58y 1m 27d. (C)

STICKLEN:

Rob Charles, son of J.C. & S.F.; d. Apr 3, 1897. (NE)

Nellie Blanche; d. Jul 24, 1894; age 3y 11m 19d. (NE)

Eliza C.; Aug 3, 185 – Jul 17, 1918. (NE)

John R.; Mar 23, 1859 – Mar 17, 1940. (NE)

Fred W.; b. Mar 7, 1880; d. Feb 25, 1881. (NE)

Estella M.; b. Aug 6, 1884; d. Sep 6, 1885. (NE)

(Above 2 Children of J.H. & F.B. Stricklen).

STODGELL:

Sarah C., wife of C.V.; d. May 1, 1878; age 30y 13d. (NC)

Luella C.; d. Feb 15, 1869; age 1m. (NC)

Luna B.; d. Mar 4, 1877; age 1y 6m 28d. (NC)

Ethel; d. Jan 1, 1878; age 2m. (NC)

Ambrose W.; d. Jul 17, 1895; age 84y 3m 8d. (NE)

John C., son of A.W. & Elizabeth; d. Oct 27, 1878; age 22y. (NE)

SWEENEY:

Robert G., son of C.H. & B.A.; d. Aug 18, 1864; age 5m 25d. (C)

Nelson; d. May 6, 1865; age 63y 2m 26d. (C)

Elizabeth B., wife of Nelson; d. Aug 14, 1894; age ----. (C)

Margaret, dau of N. & E.B.; d. Jun 5, 1865; age 18y 2m 12d. (C)

William Oswald; 1844 – 1919. Co "I" 124th IL Inf. (SC)

Bertha Louisa; 1876 – 1877. (SC)

John N.; d. Dec 8, 1889; age 23y 8m. (SC)

Infant son of J.M. & E.J.; d. Feb ---; 1873. (SC)

Mary, wife of A.M.; d. Oct 27, 1865; age 29y 4m 24d. (NE)

Ambrose M.; d. Oct 28, 1881; age 47y 3m 20d. (NE)

Mary E., wife of A.M.; b. Jun 23, 1842; d. Nov 23, 1896. (NE)

SYPHERD:

Flavius J.; d. Dec 27, 1864; age 35y 5m 1d. Co "I" 124th IL Inf. (C)

TATUM:

Catherine E., wife of Clifton; d. Feb 16, 1898; age 28y 9m 14d. (EC)

WEAR:

Caroline E. (See SHRYACK).

WOOD:

William; d. Aug 27, 1854; age 61y. War of 1812. (WC)
Mary A., wife of William; d. Aug 22, 1854; age 62y. (WC)

Genealogical Notes – Walker Cemetery

BUGG: Oliver E. (Death notice, in part, from The Macomb Journal, Sep 24, 1885): “Ollie Bugg, son of Wm. C. Bugg of near Sciota, died last Thursday at Burlington, IA, age 16 years. He had gone to visit an aunt at Yarmouth, IA....” Macomb Journal reported sudden death of Jesse W. Bugg of Emmet Twp., age 87. Died in Apr 1873. J.W. Bugg (Sr. & Jr.) both in section 7, Emmet Twp.

CORD: 1850 census #430; Henry C., 29, farmer, KY; Zelda, 27, KY; Mary, 19, KY; Sarah, 6, KY; Missouriia, 4, KY; and Martha, 2, IL.

FOLEY: Alice Foley, of Hire Twp., committed suicide in Oct 1877. A Wm. Foley, Est. in section 11, Hire Twp., also here on 40A, Thomas Foley.

GILLIAN: Rosamond (Death notice, in part, from The Macomb Journal, Jan 13, 1881): “Mrs. Rosamond Gillian, an old lady living in Emmet Twp., who for years had lived with her son-in-law, James D. Griffith, died Friday of last week, aged nearly 90 years. She was buried Sunday. She was pensioner, her husband having served in the War of 1812. “

GRIFFITH: James D. moved to this county in 1853 and settled on sec 7, Emmet; also owned a farm in Lamoine Twp.; James raised in VA and born there in Buckingham Co. on Jul 20, 1810; walked to Highland Co. OH in 1829 and worked on the Ohio Canal for 3 years; farmed there till 1853; married in 1833 to Nancy A. Gillan, a native of VA and a daughter of Wm. Gillan, vet of War of 1812; her mother later moved to this county and lived with her daughter till her death in Jan 1880; James’ father died in OH; also his mother; Griffith’s children: Mary J., later widow of David Newell; Benj. A. lived in Sciota Twp.; Henry C. moved to Blandinsville; James M. & Cary, both lived in Emmet; Virginia A., later widow of Joseph Hainline and lived in Sciota; Wm. C. lived in Hire; John A. died; Clara E.; Isaac W. and David C. James was a school director in district 2, Emmet and also a trustee at Maple Grove M.E. Church in Emmet.

Virginia Griffith, dau of James D., married Joseph Hainline; he died in 1882. Virginia died in 1941 at age 97 years; both buried in Spring Creek Cemetery.

Henry C. Griffith in 1870 lived on sec 23, Hire Twp.; a native of OH; moved here from Highland Co., OH in 1853.

Cary F. Griffith died Jan 6, 1903 in Point Arena, CA after an illness of about 2 months. He was born Dec 12, 1841 in Highland Co. OH; son of James D. and Nancy Griffith. Entered military service Aug 12, 1862; was in Co I 124th IL Inf; discharged in Chicago in Sep 1865; also had two brothers, Benj. and James, in Civil War; all wounded but none disabled. Lived at home a year then went into grocery business in Blandinsville; there 2 years; married Dec 7, 1868 in Chatauqua Co. NY to Alice A. Phelps, native of PA. Had 3 children – James D., Lawson F. & Lou Ellen. Mrs. Griffith and all 3 children living at the death of Mr. Griffith. Cary F. was McDonough Co. coroner from 1880 to 1882; moved to Point Arena, CA and was an undertaker there. Cary and his wife both school teachers in McDonough Co.; he farmed on sec 22, Emmet Twp.

David C. Griffith lived on the old family farm; he was born in this county and married on Oct 14, 1877 to Nannie T. Wotten, a native of KY; had a daughter, Winnifred M.

GRIFFITH (Cont'd): Wm. C. Griffith married Eliza Ann Hamilton; she a daughter of Andrew Jackson and Julia (Douthit) Hamilton; both parents natives of KY; Andrew J. born in 1819; moved here with parents in 1838; married in 1844 in KY; farmed in Emmet Twp.; Eliza was one of 12 children.

J.M. Griffith lived on sec 5, Emmet; b. in OH; to this county in 1853. C.F. Griffith and Henry Griffith each had farms in sec 23, Hire Twp. M. Griffith, sec 23, Sciota Twp., and B.A. Griffith, sec 21, Sciota Twp.

GUY: W. Franklin; probably son, Wm. F.; of Benj. F. & Mary J. (Ledgerwood) Guy; Benj. F. born in KY in 1835 and son of George G. and Angeline (Tinsley) Guy; grandparents moved to this county and settled in Emmet Twp.; W. Franklin was one of 9 children. Benj. married Feb 25, 1858 to Mary, dau of John and Peggy J. (Kelso) Ledgerwood; Mary born near LaHarpe, IL; Guy family lived in west part of Emmet Twp., sec 17/18. B.F. Guy was a trustee at Maple Grove M.E. Church in Emmet Twp. (See GUY Cem.).

HILL: (Possible mother of John W.) Mrs. Elizabeth M. Hill, wife of J. Hill of Plattville, CO, died Feb 14, 1911; Mrs. Hill was a sister of John Tipton, deceased, formerly of this vicinity.

HAINLINE: (Court Records) Ray Hainline died Jan 28, 1883; age 1m 2d; cause of death bronchitis; buried in Walker Cemetery.

JOHNSON: Wm. F. Johnson, native of NC; born Apr 8, 1813; moved to Mahaska Co. IA; lived there a short time and moved to this county in 1853; settled on sec 12, Emmet; had 7 children; he died Sep 24, 1883; son, Charles F., born in IN (Harrison Co.) on Feb 17, 1846; with parents till 1865; in CO 18 months; returned here and married Jul 5, 1868 to Polly Ferguson, a native of this county. (Death notice, in part, from The Macomb Journal, Sep 27, 1883): "William F. Johnson, of Hire Twp., died at his home. He is survived by his wife and his son who lives near him. He was 70 years old and had lived in the township for at least 25 years. He raised a large family of sons and daughters, all of whom are married. He was buried Monday at the Walker graveyard in Emmet....."

Cora Johnson died Dec 6, 1877 age 3y 6m; died of the croup; b. & d. Emmet Twp. George Johnson died Nov 30, 1877 of croup; age 5y; buried on Dec 1, 1877 in Emmet Twp.

Martha E. Johnson (Death Notice, in part, from The Macomb Journal Aug 18, 1881): "Mrs. Martha Johnson of Hire Twp. died last Monday aged about 30 years. She was the daughter of Winston Stodgell of Emmet Twp. and a sister of Mrs. Barbara Sweeney of Chariton Co. MO. Survived by her husband and 4 children....."

NEWELL: David; d. Dec 23, 1879 in Emmet Twp.; aged 54y; married; farmer, mechanic, & miller; born PA.

NULL: Elizabeth (Obit, in part, from The Macomb Journal, Feb 19, 1885): "Eliza Null, wife of Israel Null, died Feb 12th in Hire Twp., aged 74y 4m 7d. She was the daughter of J. Henry Cruse of Germantown, OH. She married at the age of 22 years to Israel Null of Warren Co. OH..... She was born in Westmoreland Co. PA on Oct 5, 1810. When she was 5 years old, she moved with her parents to Germantown, OH where she married Israel Null on Mar 11, 1832. From there they went to Fayette Co. IN, where they lived for 22 years, after which they came to this county, to Elm Grove, Hire Twp., where she died. She was the mother of 7 children, 3 preceding her in death. The survivors are 3 boys and 1 girl....." Israel was an active member of Elm Grove U.B. Church. Israel Null in 1870 lived on sec 15, Hire Twp.; farmer, born in OH; moved to this county in 1854 from IN. Israel and Wm. Null were trustees of Elm Grove in 1877. Wm. Null on sec 14, Hire Twp.

Sarah Atlanta Null died Feb 24, 1922; aged 80y 2m 22d; born Nov 2, 1841, in Nulltown, IN; daughter of Israel and Eliza (Cruse) Null. (Cruse spelled Cruse above). Israel born in Springborough, OH; Eliza in PA; Sarah A. Null was single.

NULL (Cont'd): Addie E. (Obit, in part, from The Macomb Journal, Jan 18, 1883): "Adda Null, wife of Henry I. Null, died at her residence in Hire Twp., on Jan 10, age about 30 years. She was the eldest daughter of Lucius Shryack of Hire Twp.... She married H.I. Null about 10 years ago and they had 4 children, the youngest being a baby aged 1 week...."

PENNINGTON: William Pennington moved to this county in 1828 from Schuyler Co.; he was born in VA on May 25, 1799; moved with parents to Greenbrier Co. KY as a child; moved to IN about 1820; there a few years and moved to IL; settled at Pennington Point in New Salem Twp. but moved to Emmet in 1831; married in IN to Rebecca Osborn, native of NC; had 10 children: Moses moved to Arkansas; Alfred lived in Blandinsville; Nancy W., died; Perry lived in Schuyler Co.; Wm. R.; Eli A.; Joel R.; John, died; Elijah; and Elisha (latter two were twins and died in infancy). His wife died previous to him and both were buried on sec 7 in Emmet Twp. Wm. died of pneumonia at age 81y 10m 26d.

Eli Pennington lived on sec 8, and owned 91A there; he also had 61A in sec 18, Emmet Twp.; Eli married Emeline Grills on May 29, 1870; she was a native of TN and they were married in this county; they had 2 children Mamie born Dec 19, 1872 and Alfre born Jan 22, 1874. Other members of the Grills family buried at Spring Creek Cemetery.

Oliver Perry Pennington was the first white child born in New Salem Twp.; born Jul 29, 1831.

Riley and Perry Pennington were directors at District 6 school, Emmet Twp. A. & E. Pennington owned land in Hire Twp., sec 12 & 13 in 1870 and sec 18 in Emmet Twp.,; Wm. sec 12, Emmet; R. in sec 7, Emmet.

SHRYACK: Cordelia; maiden name was Landsdown. She and Wm. L. Shryack were married in Apr 1883. W.L. Shryack in sec 13, Hire Twp. in 1870. L. Shryack in sec 14, Hire Twp. in 1870.

SIDERS: Henry; born in Frederick, MD; raised in VA; married Nancy Kidd, a native of VA; moved to OH shortly after marriage; moved to this county in 1856; farmed in Emmet Twp.; later moved to Macomb. Son, John W., born in Highland Co. OH on Mar 31, 1839; taught school at district 2, in the winter; moved to Plymouth, IN and edited the "Republican", a newspaper, there. Mary E. Siders also teacher at district 2.

STICKLEN: Mrs. John R. Sticklen, Ella Catherine, died at 3:00 PM on Jun 17, 1918, at her home in Emmet Twp; was aged 61y 10m 14d; ill 2 years with TB; burial in Walker Cem; dau of William & Rebecca Craig, born and raised in Emmet Twp.; married Oct 27, 1885 to John R. Sticklen; he survives along with a son Frank E. of Colchester. Also has 3 brothers living; Thomas, Rock Island; Frank, Moline; and J.D., Oregon; a sister Lola Craig, Hire Twp; a daughter, Nellie Blanche; a brother, Sherrod; and a sister, Elizabeth, all deceased.

Freddie E. died of bronchitis on Feb 26, 1881; age 11m 21d; born McDonough count.

STODGELL: John C. died Oct 27, 1878; age 23y 4m 17d; single; born Emmet Twp.; died of chronic spinal affliction and paralysis.

SWEENEY: Ambrose M. (Death notice from The Macomb Journal, Nov 3, 1881): "A.M. Sweeney of Hire Twp. died; his brother is Calvin H. Sweeney of Chariton Co. MO."

William Oswald; wife Louisa (Champion) Sweeney died in 1921 and a son, Irwin Oswald Sweeney died in 1897. Both buried in Spring Creek Cemetery.

C. Sweeney owned a farm in sec 24, Hire Twp. in 1870; E. Sweeney sec 18, Emmet Twp.

SWEENEY (Cont'd): 1850 census #204; Nelson, 49, farmer, KY; Elizabeth, 33, KY; Joseph H., 20, farmer, KY: ???, 18, male, farmer, KY; Martin A., 15, farmer, KY; Calvin, 15, KY; Herman, 12, KY; Mary A., 10, KY; John M., 7, KY; William, 6, IL; Margaret E., 4, IL; George W., 0 mos, IL.

Notes, Corrections, Additions, and Changes